

Automated Traffic Enforcement Safety Device Municipal Plan

Town of Prospect, CT

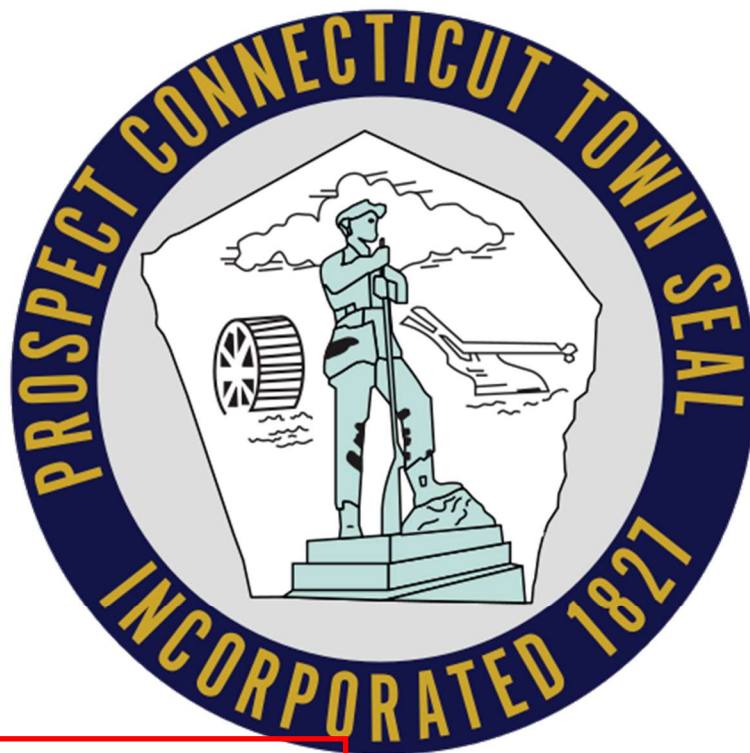

Approved by OSTA

4/9/2026

Submission Prepared by:

Director of Public Safety Nelson Abarzua

Submitted February 19th, 2026

Executive Director - State Traffic
Administration Connecticut Department of
Transportation
2800 Berlin Turnpike
Newington, CT 06131

Dear Executive Director,

Please accept this comprehensive Automated Traffic Enforcement Safety Device (ATESD) Municipal Plan for the Town of Prospect. Our ATESD plan aligns with Connecticut General Statutes § 14-307c. (2024) as well as the Connecticut Department of Transportation's traffic safety goals and initiatives. It is designed to reduce the dangerous conditions within our community overall, and at the selected locations specifically. These dangerous conditions contribute to traffic collisions, serious injuries, and deaths involving pedestrians, bicyclists, motorists and vulnerable roadway users on our roads.

To prepare this Municipal Plan, we followed the recommended guidelines and completed the required traffic assessments. These efforts helped to determine the specific roadway locations that we believe will benefit most from automated traffic enforcement. The justification, traffic assessment data, and methodology for the site selection are attached within. For each location, you will note additional imagery and relevant information that identifies the intended application of the ATESDs.

We hope that you will agree this plan is equitable, that it is likely to improve traffic safety at the proposed locations, and warrants approval. We recognize that this is a collaborative process and look forward to any feedback the Office of the State Traffic Administration may have to enhance the safety benefits of this proposal. If there are any questions we may answer, or additional documentation we may provide, please do let us know.

Nelson Abarzua

Nelson Abarzua
8 Center Street
Prospect, CT, 06712
203-758-6609
ltabarzua@prospectpolice.org

Table of Contents

- ATESD PROGRAM: REQUIRED DOCUMENTS 2**
- A. ATESD SELF-CERTIFICATION 2**
- B. ATESD MUNICIPAL ORDINANCE 3**
- C. PUBLIC HEARING & PLAN APPROVAL 9**
- D. MUNICIPAL SAFETY ACTION PLAN 23**
- E. GENERAL MUNICIPAL DATA 26**
- I. NUMBER OF TRAFFIC STOPS CONDUCTED..... 26
- II. EQUITY DATA 26
- III. QUALIFIED CENSUS TRACT IDENTIFICATION 26
- PROPOSED ATESD SPEED CAMERA SITES 27**
- 1. WATERBURY RD (SR-69) SOUTH OF OAK LN 27
- 2. NEW HAVEN RD. (SR-69) NORTH OF TALMADGE HILL RD 32
- 3. CHESHIRE RD (SR-68) WEST OF MATTHEW ST 37
- MUNICIPAL PLAN CONTACT INFORMATION 43**



ATESD PROGRAM: REQUIRED DOCUMENTS

A. ATESD Self-Certification



STATE OF CONNECTICUT
OFFICE OF THE STATE TRAFFIC ADMINISTRATION
DEPARTMENT OF TRANSPORTATION
2800 BERLIN TURNPIKE
NEWINGTON, CT 06111
Email: DOT.OSTA@ct.gov



AUTOMATED TRAFFIC ENFORCEMENT SAFETY DEVICE (ATESD) MUNICIPAL SELF-CERTIFICATION

I, THE UNDERSIGNED Mayor Robert J. Chatfield, hereby certify that I have read [Sections 14-307b through 14-307h](#) of the General Statutes of Connecticut concerning municipal use of Automated Traffic Enforcement Safety Devices (ATESD). I understand that the requirements associated with implementation of an ATESD program include, but are not limited to, the following:

- The municipality cannot install an ATESD until its ATESD Plan has been approved by CTDOT's Office of the State Traffic Administration (OSTA).
- That the municipality shall develop a public awareness campaign to educate the public concerning ATESDs and that the campaign be implemented at least 30 days *before* the first ATESD is operational.
- The municipality may enter into agreements with vendors for the design, installation, operation or maintenance, or any combination thereof, of automated traffic enforcement safety devices. If a vendor designs, installs, operates, or maintains an automated traffic enforcement safety device, the vendor's fee may *not* be contingent on the number of citations issued or fines paid.
- For the first 30 days the ATESD is operational, only a written warning can be issued by the municipality. After 30 days, the municipality may establish a fine not more than fifty dollars for a first violation and not more than seventy-five dollars for a second or subsequent violation.
- The municipality may impose a reasonable fee, not to exceed fifteen dollars, for the costs associated with the electronic processing of the payment of any such fine.
- Any funds received by a municipality from fines imposed shall be used for the purposes of improving transportation mobility, investing in transportation infrastructure improvements, or paying the costs associated with the use of automated traffic enforcement safety devices in the municipality.
- The municipality shall ensure each ATESD undergoes an annual calibration check performed at a calibration laboratory. The calibration laboratory shall issue a signed certificate of calibration after the annual calibration check.



Signature of Chief Elected Official

Town of Prospect

Name of Municipality

2/13/24

Date

Equal Opportunity Employer

B. ATESD Municipal Ordinance

246

Authorized by Public Act 23-116; Codified as CGS §14-307c

TOWN OF PROSPECT ORDINANCES
Ordinance # 99-01-08-2025

ORDINANCE AUTHORIZING THE USE OF AUTOMATED TRAFFIC ENFORCEMENT
SAFETY DEVICES

Sec. 1 Use of Automated Traffic Enforcement Safety Devices.

Pursuant to the authority granted in and by Connecticut General Statutes (CGS) § 14-307c, the so-called ATESD Act (the "Act") as such statute may be from time to time amended, the Town of Prospect (the "Town") does hereby authorize the deployment and use of Automated Traffic Enforcement Safety Devices (alternately referred to as "ATESD"; "Device": "Devices", "Apparatus") at locations identified in a plan submitted to and approved by the Connecticut Department of Transportation ("Conn.DOT") within school zones, pedestrian safety zones, and other places within the boundaries of Prospect, Connecticut.

Sec. 2 Definitions.

For the purposes of this ordinance and as authorized by the Act, the following words, terms, and phrases used in this ordinance shall have the meanings and definitions ascribed to them in said CGS § 14-307c and as follows:

(a) Automated traffic enforcement safety device ("ATESD") means a Device or Apparatus designed to detect and collect evidence of alleged traffic violations by recording images that capture the number plate, date, time, and location of a motor vehicle that (i) exceeds the posted speed limit by ten (10) or more miles per hour or (ii) fails to stop such vehicle when facing a steady red signal on a traffic control signal.

(b) Automated traffic enforcement safety device operator ("Operator") means and is a person who is trained and certified to operate an automated traffic enforcement safety device.

(c) Pedestrian safety zone means an area designated by the Office of State Traffic Administration or the Prospect Traffic Authority ("Traffic Authority") pursuant to CGS §14-307a.

(d) Personally identifiable information means information created or maintained by the Town or a vendor that identifies or describes an owner and includes, without limitation, the owner's address, telephone number, number plate, photograph, bank account, credit and/or debit card number, or the date, time, location, or direction of travel on a highway.

(e) Driver, number plate and owner have the same meanings as ascribed to those words as provided in and by CGS section 14-1

(f) School zone means an area designated by the Office of State Traffic Administration or the Traffic Authority pursuant to CGS § 14-212b.

(g) Traffic authority, traffic control sign, and traffic control signal all have the same meanings as provided in CGS § 14-297,

(h) Vendor means a person or entity that provides services to the Town pursuant to this ordinance and operates, maintains, leases, or licenses Apparatus, or is authorized to review and assemble the recorded images captured by an ATESD device and forward such recorded images to the Town.

Sec. 3 Vendors.

The Town may enter into contracts with vendors for the design, installation, operation, or maintenance, or any combination thereof, of Apparatus and ATESD services. If a vendor designs, installs, operates, or maintains a Device, the vendor's fees may not be contingent on the number of citations issued or fines levied or paid pursuant to this ordinance. Notwithstanding any Municipal Purchasing procedures set forth in the Town of Prospect Ordinances, contracts may be solicited and awarded to vendors by employment of the State of Connecticut bidding process, or by way of the processes and procedures of said Ordinances. The vendor solicitation process employed shall be that selected by the Town in its sole discretion. In the event of a conflict between any ordinance and this ordinance relating to the purchase or lease of Apparatus and related services, the provisions of this ordinance shall control. The ultimate selection of vendors and awarding of contracts shall be made by the Town in consultation with the Commander of CSP Troop I Bethany or their designee. All contracts for such Devices, and directly related ATESD services must be in writing. Notwithstanding any express or implied term or provision of any ordinance to the contrary, the approval by the legislative body to permit the Mayor to execute all such contracts shall be granted at the time of the adoption hereof.

Sec. 4 Operation of Automated Traffic Enforcement Safety Devices (ATESDs).

All automated traffic enforcement safety devices shall be operated by an automated traffic enforcement safety device operator.

Sec. 5 Violation.

(a) The owner of a motor vehicle commits a violation of this ordinance if the person operating such motor vehicle:

(1) Exceeds the posted speed limit by **ten (10) or more miles per hour** and such operation is detected by an automated traffic enforcement safety device; or

(2) Fails to stop such motor vehicle when facing a steady red signal on a traffic control signal and such failure is detected by an automated traffic enforcement safety device.

(b) Automated traffic enforcement safety devices shall be used solely for identifying violations of this ordinance.

(c) For the first thirty (30) days after a location is equipped with an operational Device, the owner of a motor vehicle that allegedly violates this ordinance that is detected by such device shall receive a written warning instead of a citation.

(d) Whenever an automated traffic enforcement safety device detects and produces recorded images of a motor vehicle allegedly committing a violation of this ordinance, a sworn Prospect Police Officer or such other Town employee designated by the Prospect Town Council, shall review and approve the recorded images provided by such device. If, after such review, the member or employee determines that there are reasonable grounds to believe that a violation occurred, the member or employee may issue by first class mail a citation to the owner of such motor vehicle.

(e) A citation under this ordinance shall include the following:

(i) The name and address of the owner of the motor vehicle;

(ii) The number plate of the motor vehicle;

(iii) The violation charged;

(iv) The location of the automated traffic enforcement safety device and the date and time of the violation;

(v) Information on how to view, through electronic means, the recorded images that capture the alleged violation;

(vi) A statement or electronically generated affirmation by the member or employee who viewed the recorded images and determined that a violation occurred;

(vii) Verification that the automated traffic enforcement safety device was operating correctly at the time of the alleged violation and the date of the most recent calibration check performed pursuant to the Public Act;

(viii) The amount of the fine imposed and how to pay such fine; and

(ix) The right to contest the violation and request a hearing pursuant to CGS § 7-152c.

(f) 1. In the case of an alleged violation involving a motor vehicle registered in Connecticut, the citation shall be sent by first class mail not later than thirty (30) days after the identity of the owner is determined and shall be mailed to the address of the owner that is in the records of the Department of Motor Vehicles.

2. In the case of an alleged violation involving a motor vehicle registered in another jurisdiction, the citation shall be sent by first class mail not later than thirty (30) days after the identity of the owner is determined and shall be mailed to the address of the owner that is in any official record or the Motor Vehicle Department in the other jurisdiction issuing such registration.

(g) A citation not mailed to an owner within sixty (60) days after the alleged violation shall be invalid.

Sec. 6 Enforcement and Fine.

(a) This ordinance may be enforced by any sworn officer of the Connecticut State Police or a sworn Town of Prospect Police Officer such citation shall impose a fine against the owner of a motor vehicle that commits a violation of this ordinance.

(b) The fine for a first violation of this ordinance shall be **fifty dollars (\$50.00)**. The fine for each subsequent violation of this ordinance shall be **seventy-five dollars (\$75.00)**. These fines shall be imposed against the owner of the motor vehicle committing a violation of this ordinance.

(c) Payment of a fine and any associated fees may be made by electronic means.

(d) A **fifteen dollar (\$15.00)** fee shall be imposed for costs associated with the electronic processing of the payment of a fine.

(e) Any funds received by the Town from fines imposed pursuant to this ordinance shall be used for the purposes of improving transportation mobility, investing in transportation infrastructure improvements, or paying the costs associated with the use of automated traffic enforcement safety devices within the Town.

Sec. 7 Appeal.

Any owner issued a fine for violating the provisions of this ordinance may, within ten (10) days of the receipt of the fine, appeal in writing to a citation hearing officer in accordance with CGS § 7-152c, the provisions of which relating to hearing procedure are included herein, adopted and made a part hereof by reference.

Sec. 8 Defenses.

The defenses available to the owner of a motor vehicle that is alleged to have committed a violation of this ordinance shall include, but are not limited to, any one or more of the following:

- (a) The operator was driving an emergency vehicle in accordance with the applicable provisions of CGS § 14-283.
- (b) The traffic control signal was inoperative, which is observable on the recorded images.
- (c) The violation was necessary for the operator to comply with an order or direction from a law enforcement officer, which is observable on the recorded images.
- (d) The violation was necessary to allow the passage of an authorized emergency vehicle, which is observable on the recorded images.
- (e) The violation took place during a period of time in which the motor vehicle had been reported as being stolen to a law enforcement unit, as defined in CGS § 7-294a, and had not yet been recovered prior to the time of the violation.
- (f) The automated traffic enforcement safety device was not in compliance with the calibration check required pursuant to the applicable provisions of the Act.

Sec. 9 Disclosure of Personally Identifiable Information.

- (a) No personally identifiable information shall be disclosed by the Town or a vendor to any person or entity, including any law enforcement unit, except where the disclosure is made in connection with the charging, collection, and enforcement of the fines imposed pursuant to this ordinance.
- (b) No personally identifiable information shall be stored or retained by the Town or a vendor unless such information is necessary for the charging, collection, and enforcement of the fines imposed pursuant to this ordinance.
- (c) The Town or a vendor shall destroy all personally identifiable information and other data that specifically identifies a motor vehicle and relates to a violation of this ordinance not later than thirty (30) days after any fine is collected or the resolution of a hearing conducted for the alleged commission of such violation, whichever is later.
- (d) Any information and other data gathered from automated traffic enforcement safety devices shall be subject to disclosure under the Freedom of Information Act, as defined in CGS § 1-200, except that no personally identifiable information may be disclosed.

Sec. 10 Compliance with CGS § 14-307c and Savings Provision.

To the extent of applicability and/or in the event this ordinance omits any material statutory element or requirement, the provisions of the Act that are necessary to further and/or effectuate this ordinance or to render this ordinance compliant with the Act are hereby incorporated and adopted in toto, herein.

Sec. 11 Severability and Repealer.

If any section, subsection, sentence, clause or phrase of this ordinance is for any reason held to be invalid or unconstitutional by any decision of any court of competent jurisdiction, such decision shall not affect the validity of the remaining portions of this ordinance. All ordinances, bylaws, orders, resolutions, or parts thereof, inconsistent herewith are hereby repealed only to the extent of such inconsistency. This repealer shall not be construed to revive any ordinances, bylaws, orders, resolutions, or parts thereof, heretofore repealed.

Sec. 12 Amendment by operation of law.

Should CGS § 14-307c be amended or revised, then and in those events, this ordinance shall be automatically amended and revised to conform to such statutory revisions.

Approval: January 8, 2026
Recorded: January 9, 2026
Published: January 16, 2026
Effective: February 17, 2026

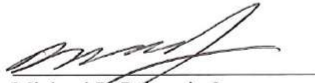
Michael P. Palmerie Jr.
Prospect Town Council

Michelle Lisowski
Prospect Town Clerk

Dated at Prospect, Connecticut this 13th day of January 2026.





C. Public Hearing & Plan Approval

Agenda and Meeting Minutes on Town Website

In accordance with applicable Open Meetings Act requirements and transparency standards, the Town of Prospect ensures that the public is fully informed of all Town Council meetings.

Meeting agendas are published on The Town of Prospect's website: <https://townofprospect.gov/agendas-minutes/> and The Waterbury Republican American Newspaper in advance of each meeting. The official meeting minutes are posted on the town website following their approval.

These measures are being taken to promote transparency, accountability, and full public participation in local government.

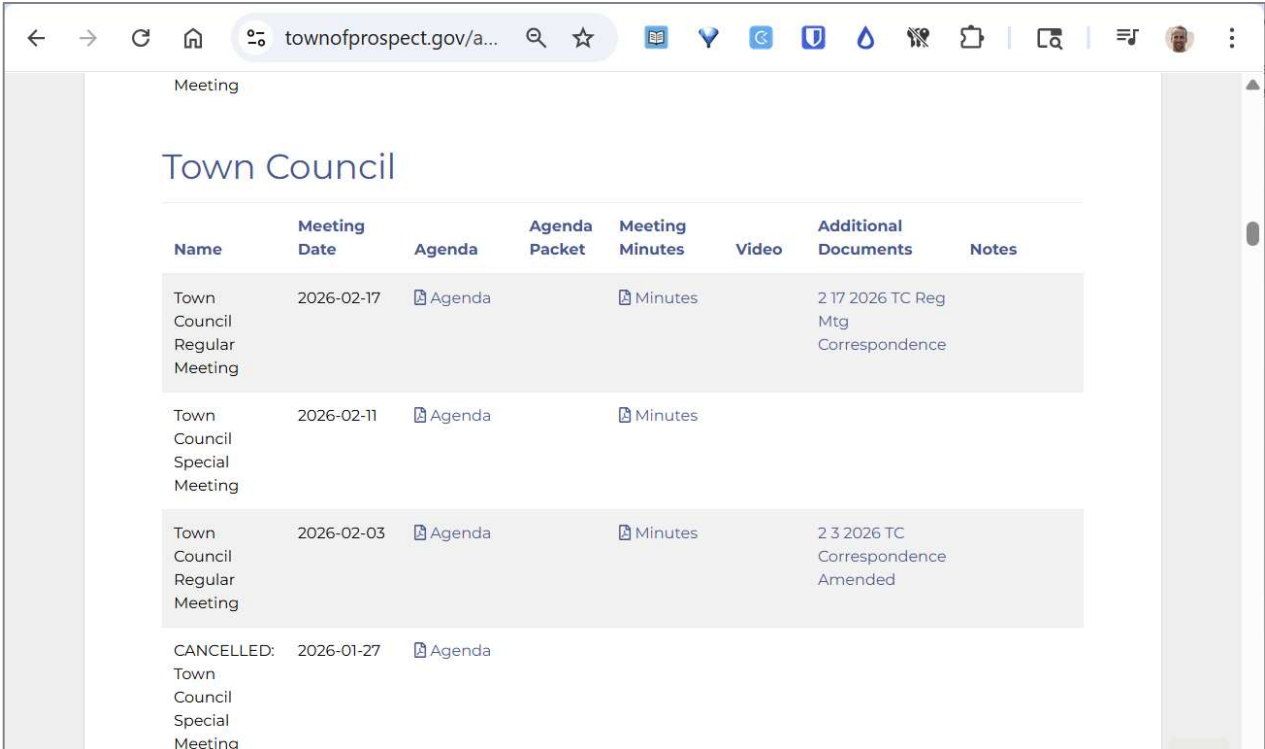

The screenshot shows a web browser window with the URL 'townofprospect.gov/a...'. The page title is 'Meeting' and the main heading is 'Town Council'. Below the heading is a table with columns: Name, Meeting Date, Agenda, Agenda Packet, Meeting Minutes, Video, Additional Documents, and Notes. The table lists four meetings: a regular meeting on 2026-02-17, a special meeting on 2026-02-11, another regular meeting on 2026-02-03, and a cancelled special meeting on 2026-01-27.

Name	Meeting Date	Agenda	Agenda Packet	Meeting Minutes	Video	Additional Documents	Notes
Town Council Regular Meeting	2026-02-17	Agenda		Minutes		2 17 2026 TC Reg Mtg Correspondence	
Town Council Special Meeting	2026-02-11	Agenda		Minutes			
Town Council Regular Meeting	2026-02-03	Agenda		Minutes		2 3 2026 TC Correspondence Amended	
CANCELLED: Town Council Special Meeting	2026-01-27	Agenda					

Public Hearing Announcement



Waterbury Republican American

New Haven County,
Litchfield County

Public notice

Run Dates: **December 23 2025**

TOWN OF PROSPECT LEGAL NOTICE OF PUBLIC HEARING

Automatic Traffic Enforcement Safety Devices and

Property Tax Exemption for 100% Disabled Veterans The

Town of Prospect will be holding a Public Hearing to

discuss two items: Automatic Traffic Enforcement Safety

Devices and Property Tax Exemption for 100% Disabled

Veterans to be extended to surviving spouse upon passing

of veteran. The hearing will be held on Thursday, January

8, 2026 at 7 PM at Town Hall in the downstairs assembly

room. Michael Palmerie, Chairman Prospect Town Council

Dated at Prospect, CT This 19th day of December, 2025

[View less](#)

Uploaded December 23, 2025 10:40 AM

Classified

ctnsider.com/Waterbury • 203-333-4151 • classifieds@hearstmediact.com • Hours: Monday - Friday 8 am - 3:30 pm

PUBLIC NOTICES

LEGAL NOTICE
In accordance with the General Statutes, Sec. 13-141, notice is hereby given that the second half of the 2008 Grand List of Real Estate, Personal Property and Motor Vehicle Tax, along with the early supplemental bills payable in due and payable in the Town of Waterbury on January 1, 2009.

Taxes become delinquent on February 1, 2009.

NO ADDITIONAL BILL IS ISSUED FOR THE SECOND HALF.

Delinquencies are subject to interest charges at a rate of 1.5% per month for 180 days, 2.0% for 181 days, and 3.0% thereafter.

All taxes must be made payable to:
Tax Collector - Registrar
First Street
Waterbury, CT 06485

Taxes may be paid at the Tax Collector's Office, Monday through Thursday, 9:00 am - 5:00 pm, and Friday 9:00 am - 1:00 pm.

**BANK OF AMERICA
TAX COLLECTOR, WATERBURY**

TAX COLLECTOR'S NOTICE
Pursuant to §§ 12-101 of the Code, the unincorporated City of Waterbury, Tax Collector, does hereby call and call to the attention of the owners of Real Estate and Personal Property, and Motor Vehicle Tax, that the second half of the 2008 Grand List of Real Estate, Personal Property and Motor Vehicle Tax, along with the early supplemental bills payable in due and payable in the Town of Waterbury on January 1, 2009.

Taxes become delinquent on February 1, 2009.

Delinquencies are subject to interest charges at a rate of 1.5% per month for 180 days, 2.0% for 181 days, and 3.0% thereafter.

All taxes must be made payable to:
Tax Collector - Registrar
First Street
Waterbury, CT 06485

Taxes may be paid at the Tax Collector's Office, Monday through Thursday, 9:00 am - 5:00 pm, and Friday 9:00 am - 1:00 pm.

**BANK OF AMERICA
TAX COLLECTOR, WATERBURY**

PUBLIC NOTICES

NOTICE OF TAXES FOR 2008
The second half of the 2008 Grand List of Real Estate and Personal Property taxes on the Grand List of October 1, 2008, and the taxes that qualify for the early supplemental bills payable in due and payable in the Town of Waterbury on January 1, 2009, are hereby called and call to the attention of the owners of Real Estate, Personal Property and Motor Vehicle Tax, that the second half of the 2008 Grand List of Real Estate, Personal Property and Motor Vehicle Tax, along with the early supplemental bills payable in due and payable in the Town of Waterbury on January 1, 2009.

Taxes become delinquent on February 1, 2009.

Delinquencies are subject to interest charges at a rate of 1.5% per month for 180 days, 2.0% for 181 days, and 3.0% thereafter.

All taxes must be made payable to:
Tax Collector - Registrar
First Street
Waterbury, CT 06485

Taxes may be paid at the Tax Collector's Office, Monday through Thursday, 9:00 am - 5:00 pm, and Friday 9:00 am - 1:00 pm.

**BANK OF AMERICA
TAX COLLECTOR, WATERBURY**

At Your Service Directory

LAN & GARDEN SERVICES
Pawnee's Landscaping & Home Improvement LLC of 28 Quaker Street, Waterbury, CT 06485. Phone: 203-333-2222

ROOFING, SOING CUTTERS
ROOFING I

MASONRY PAVING
BELL'S MASONRY Contracting Masonry work. Call today for free estimates. 203-333-1177. In Area

THE PROPERTY'S OUT CLASSIFIED WORKS
Call Classified at 203-333-4151
Monday - Friday 8:30 am to 5:30 pm

TREE SERVICES

2025 DEC 29 AM 10:08

PROSPECT CORN TOWN CLERKS OFFICE

PUBLIC NOTICES

LEGAL NOTICE
In accordance with the General Statutes, Sec. 13-141, notice is hereby given that the second half of the 2008 Grand List of Real Estate, Personal Property and Motor Vehicle Tax, along with the early supplemental bills payable in due and payable in the Town of Waterbury on January 1, 2009.

Taxes become delinquent on February 1, 2009.

Delinquencies are subject to interest charges at a rate of 1.5% per month for 180 days, 2.0% for 181 days, and 3.0% thereafter.

All taxes must be made payable to:
Tax Collector - Registrar
First Street
Waterbury, CT 06485

Taxes may be paid at the Tax Collector's Office, Monday through Thursday, 9:00 am - 5:00 pm, and Friday 9:00 am - 1:00 pm.

**BANK OF AMERICA
TAX COLLECTOR, WATERBURY**

PUBLIC NOTICES

LEGAL NOTICE
In accordance with the General Statutes, Sec. 13-141, notice is hereby given that the second half of the 2008 Grand List of Real Estate, Personal Property and Motor Vehicle Tax, along with the early supplemental bills payable in due and payable in the Town of Waterbury on January 1, 2009.

Taxes become delinquent on February 1, 2009.

Delinquencies are subject to interest charges at a rate of 1.5% per month for 180 days, 2.0% for 181 days, and 3.0% thereafter.

All taxes must be made payable to:
Tax Collector - Registrar
First Street
Waterbury, CT 06485

Taxes may be paid at the Tax Collector's Office, Monday through Thursday, 9:00 am - 5:00 pm, and Friday 9:00 am - 1:00 pm.

**BANK OF AMERICA
TAX COLLECTOR, WATERBURY**

Little Stevie's TREE WORK

SPECIALIZING IN DIFFICULT TAKE DOWNS
85' BUCKET TRUCK
EXCAVATOR & LAND CLEARING
B/CITIZEN DISCOUNT
FULLY INSURED

203-300-0376

WANTED TO BUY WANTED TO BUY

Buying Costume, Gold, Silver & Fashion Jewelry

Call Jude (203) 868-1816

2025 DEC 29 AM 10:08

PROSPECT CORN TOWN CLERKS OFFICE

PUBLIC NOTICES

LEGAL NOTICE
In accordance with the General Statutes, Sec. 13-141, notice is hereby given that the second half of the 2008 Grand List of Real Estate, Personal Property and Motor Vehicle Tax, along with the early supplemental bills payable in due and payable in the Town of Waterbury on January 1, 2009.

Taxes become delinquent on February 1, 2009.

Delinquencies are subject to interest charges at a rate of 1.5% per month for 180 days, 2.0% for 181 days, and 3.0% thereafter.

All taxes must be made payable to:
Tax Collector - Registrar
First Street
Waterbury, CT 06485

Taxes may be paid at the Tax Collector's Office, Monday through Thursday, 9:00 am - 5:00 pm, and Friday 9:00 am - 1:00 pm.

**BANK OF AMERICA
TAX COLLECTOR, WATERBURY**

PUBLIC NOTICES

LEGAL NOTICE
In accordance with the General Statutes, Sec. 13-141, notice is hereby given that the second half of the 2008 Grand List of Real Estate, Personal Property and Motor Vehicle Tax, along with the early supplemental bills payable in due and payable in the Town of Waterbury on January 1, 2009.

Taxes become delinquent on February 1, 2009.

Delinquencies are subject to interest charges at a rate of 1.5% per month for 180 days, 2.0% for 181 days, and 3.0% thereafter.

All taxes must be made payable to:
Tax Collector - Registrar
First Street
Waterbury, CT 06485

Taxes may be paid at the Tax Collector's Office, Monday through Thursday, 9:00 am - 5:00 pm, and Friday 9:00 am - 1:00 pm.

**BANK OF AMERICA
TAX COLLECTOR, WATERBURY**

Did You Know?

According to the National Sleep Foundation, certain foods may help people fall asleep faster and sleep more soundly while others may compromise a person's ability to enjoy a restful night's sleep. In lieu of white bread, refined pasta and sugared baked goods, all of which can reduce serotonin levels, the NSF recommends whole grains. The buildup of serotonin in the brain during periods of wakefulness can contribute to the onset of sleep later in the day. If serotonin levels in their brains are disturbed, then people may experience difficulty falling asleep. The NSF also recommends almonds and walnuts, which contain melatonin, a hormone that helps to regulate the sleep/wake cycles. In addition, foods that are high in lean protein that contain the amino acid tryptophan also may increase the production of serotonin, potentially contributing to a restful night's sleep.

2025 DEC 29 AM 10:08

PROSPECT CORN TOWN CLERKS OFFICE



Public Hearing Meeting Minutes

Prospect Town Council
January 8, 2026
Public Hearing
Unapproved Minutes

Chairman Michael Palmerie Jr. called to order the Public Hearing @ 7:00 p.m. The meeting was in person at the Prospect Town Hall. The meeting began with the Pledge of Allegiance.

Organizer of Meeting Present: M. Palmerie Jr. A call for attendance was taken by Chairman Michael Palmerie Jr.
Council Members Present: Mike Palmerie Jr., Rich Blanc, Stan Pilat, Scott Martin, Christina Inzitari, Loreen Elbakry (7:04 p.m.), Jessica Hughes
Council Members Absent: Roger Sherman Jr., Chaka Felder
Others Present: Mayor Robert Chatfield

M. Palmerie read into the record the Legal Notice of the Public Hearing that was posted in the paper.

*"TOWN OF PROSPECT LEGAL NOTICE OF PUBLIC HEARING: Automatic Traffic Enforcement Safety Devices and Property Tax Exemption for 100% Disabled Veterans
Town of Prospect will be holding a Public Hearing to discuss items: Automatic Traffic Enforcement Safety Devices and Property Tax Exemption for 100% Disabled Veterans to be extended to their surviving spouse upon passing of veteran. The hearing will be held Thursday, January 8, 2026 at 7 p.m. at Town Hall in the downstairs assembly room."*

M. Palmerie explained the protocol of a Public Hearing.

- **Automatic Traffic Enforcement Safety Devices**

Lt. Nelson Abarzua and Sgt. Carrier are in attendance to explain and answer any questions.

Lt. Abarzua explained that the Council and Public have expressed concerns regarding traffic, accidents etc. They presented a slideshow.

Sgt. Carrier Explained where the problem locations are. He also reviewed where accidents have been in town from 2020-2025.

An Ordinance was passed by the State Legislature in 2023 allowing towns to implement their own traffic safety devices.

They commissioned a speed study that measured how much traffic comes through Prospect and actual speeds. In a 30-day period, 1,164,650 vehicles came through Town. 99,460 traveling at a speed of at least 11 miles over the speed limit and 6,920 cars going 21 plus miles over the speed limit.

Lt. Abarzua explained the Flock Camera system. In the previous 2 years before the Flock cameras were installed there were 18 stolen motor vehicles. Since the Flock, in 2025 they had 1 stolen motor vehicle. Lt. Abarzua referred to Middletown and their statistics. Their speed has decreased drastically. He also mentioned Winchester has 1 camera that has changed their driving habits as well.

Sgt. Carrier explained that the cameras need to be set to flag vehicles going at least 10 miles per hour over the speed limit. The cameras capture the rear of the vehicle and license plate. No photo is taken of the occupants. The installation of the cameras will be publicized and put on social media. There will also be signs before the camera "Speed Enforcement Ahead". In the first 30 days there will be zero monetary citations. If you are caught on that camera, you receive a warning. There is no facial recognition. The data is stored only as long as necessary. It does not affect Driver's Licenses. It's a violation of a Town Ordinance. This is not a speeding ticket; it's a civil fine. The DMV does not get notified. Insurance companies don't get

notified. The registered owner of that vehicle receives the citation. Fines will be implemented after the 30-day warning period. By State Statute, it will be a \$50 fine for the first offense. The municipality will also add a processing fee of \$15. Repeat Offenses will be fined \$75 plus processing fee.

Yes, they still have due process. They can contest or dispute. They can request to be heard by a hearing officer and will be notified by certified letter. If it gets to a point and a Town chooses, it can go to collections if you refuse to pay the fine.

Lt. Abarzua explained that this is to change the driving habits of people and not penalize people.

Sgt. Carrier explained they are trying to provide residents with the best service possible. The Cameras will be there for 24/7, monitoring while officers are going to calls, driving around addressing other things. The revenue from the camera violations comes to the Town of Prospect.

Peter Thiel, 4 Matthew Street asked of these fatal accidents, what percentage of them are caused by speeding. Lt. Abarzua stated that the Talmadge Hill Road and Rt. 69 accident was definitely due to speeding. The July 4th motorcycle was not speeding but is still under investigation. Peter asked how many live in Town. The Lt. stated he doesn't have those numbers. Peter asked what percentage they expect to see the speeding drop. Sgt. Carrier explained statistics. They would have to report back to the State in 18 months. Lt. Abarzua expects it to drop drastically. The same thing happened when they put the speed hump on Straitsville Road.

Beth Hayes, 57 Scott Road is wondering if they are putting a camera on Scott Road. Lt. Abarzua stated at the present time no. However, if statistics show they are helping, he foresees cameras will be installed on Scott Road and other locations.

Frank Monteiro, 23 Alison Court stated that he is totally in support of this. He referred to Charleston, Rhode Island. They also invested in a mobile one that they rotate around. He is curious about what that would cost us. He thinks it would be well worth the investment. He also asked where the funds go and how they are used.

Sgt. Carrier explained that they have to follow the law that was passed. There is a permitting process. They would not be able to utilize a mobile camera at this time. They have to follow a procedure. CT Statutes states what the money can be used for. They are working with UCONN traffic studies and they are gathering data daily, weekly and monthly. The funds need to be used for traffic enhancement for the Town of Prospect.

Kim Palmerie, 19 Ambert Court asked if there is an unregistered vehicle, or if a vehicle has later to be found part of an accident or some kind of crime, can this evidence be utilized in that discovery. Lt. Abarzua explained that the Flock system would be used for that. Sgt. Carrier explained that this particular camera is specifically for speeding. The other Flock system is better with stolen vehicles etc. It is more of an investigative tool.

Mayor Chatfield thanked everyone for coming tonight. Over the years they have done several things to try and make the roads safer.

Lt. Abarzua stated he is still working with engineers to get a yellow blinking light at the intersection of Rt. 68/Talmdage/Matthew. The money could be used for LED stop signs etc.

Katie Reed, 10 Hemlock Road thanked everyone for considering this. She asked the locations of the cameras they are looking to install. Lt. explained: Rt. 68 in the valley on the Naugatuck side, Rt. 68 near Skrip's Auto, Rt. 69 on the Waterbury side near the car wash and Rt. 69 near Talmdage Hill Road. Katie stated she didn't hear anything about cost. The Lt. explained the \$15 surcharge which the company takes to cover their costs. This would be at no cost to the Town or the Taxpayers. Sgt. Carrier stated that the Town of Prospect will never send the company any money. The data goes to the camera system company and any vehicles going 11 plus mph over the speed limit will be flagged. There will be 2 monitors, employees of the Police Dept. The Town owns and controls the data. We will need to add extra staffing to the Police Dept. The cameras are calibrated once per year and certified every year. The cameras are also dual direction camera.

Peter Thiel, 4 Matthew Street stated he has been a resident for 36 Years. He lives at the corner of Rt. 68 and Matthew Street. He wanted to state that the issue regarding Tax Relief for Veterans, he supports 100%. Regarding speed cameras, he read a letter into the record. He mentioned all the tracking by all the electronics, technology etc. He feels our freedoms are being eroded. He understands that in this case, it makes law enforcement much easier. Speed cameras are constant surveillance. Where does the surveillance stop? It doesn't. He is against excessive speeding but even more against constant surveillance. He mentioned the future 20 cameras discussed at the last meeting. He mentioned that he has never seen a speed trap on Rt. 68. When he complained he was told by 2 different officers, there is nothing they can do about it. Is this a budget problem? He also asked the name of the company. At this point the data isn't sold but that doesn't mean it won't be changed in the future. He urges the Town Council to reject the use of Speed Cameras in the Town of Prospect. He mentioned starting a conversation with the State Police and increasing the Police Dept. budget.

Mayor Chatfield referred to Mr. Thiel's property. His garage has been impaled 2x and the stone wall as well. They keep trying to do things to make things safer. He urges the Council to adopt the ordinance.

Joe Capuano, 32 Luke Street, asked where the Flock cameras are located. Lt. Abarzua and Sgt. Carrier stated Rt. 68, Rt. 69, Scott Road and Summit Road; on the edges of the Town. Joe stated that he had no idea they were there. He asked if the cameras will be removed depending on effectiveness of the cameras. Sgt. Carrier explained that after 18 months, they review the statistics and their permit. It can be amended in the future. Permits are good for 3 years and they are only for locations that were approved. Lt. explained the permitting process.

James Borbas Jr, Beach Drive stated that he just heard there will be no referendum on this. Why is this not going to referendum? He asked why major decisions in Town don't go to Referendum. He blames the State and changing the entire way law enforcement works. He referred to the statistics. He just sees this as a money-making scam. The Town of Washington, in 6 months made \$600,000; the majority came from

residents. We have freedom to travel without being subjected to undue process. He feels it is reprehensible that this is not going to a Town Referendum where every taxpayer can vote on it.

Mayor Chatfield explained that the people in town are speeding on their own roads. 1 death is too many.

There were no other public comments. Discussion ended on the above topic at 8:09 p.m.

• **Property Tax Exemption for 100% Disabled Veterans**

Mayor Chatfield stated that he is in support of the disabled veterans tax exemption. The family continues to get the tax abatement after the veteran passes. They served our country; they deserve for us to take care of them after they are gone.

M. Palmerie explained that this would be a tax abatement given to 100% disabled veterans "legal spouse".

James Borbas Jr. Beach Drive stated that he supports the tax abatement 100%. He would like to see this expand in the future to anyone living in town for 40 years or more.

There were no other public comments.

Council Comments:

J. Hughes asked Lt. Abarzua who decides where the revenue goes that comes from the speed cameras. Who decides what traffic improvements are made? Lt. explained that it would still have to come to the Council and it would have to be in accordance with CT General Statute. Examples: New stops signs, radar machines etc. The Council can definitely make recommendations.

S. Pilat asked how often the information gets downloaded from the vendor. Lt. stated it's downloaded daily. He asked if it could be real time. Lt. stated probably. S. Pilat asked if they can set the triggering speed at any speed they want. Lt. and Sft. Stated it can't be any lower than over 10 miles per hour. S. Pilat asked if the speed limit can be changed in the future. Lt. Abarzua stated he would refer to the Flock System for tracking certain vehicles. S. Pilat asked if in the future there would be the ability to use that information to track someone through Town. Lt. stated that scenario is not feasible.

C. Inzitari asked who pays the processing fee. Lt. Abarzua stated the surcharge is paid by the person who received the ticket. Lt. explained. C. Inzitari asked the name of the company. Lt. Abarzua stated DACRA Tech LLC. C. Inzitari asked if the Town could use the funding for safety infrastructure not pertaining to the cameras. Lt. stated yes.

R. Blanc asked if a person can get 2 tickets in the same day. Lt. Abarzua stated yes.

The Public Hearing ended at 8:21 p.m.

Michael Palmerie Jr., Town Council Chairman

PROSPECT, CONN
TOWN CLERK'S OFFICE
2026 JAN 12 AM 8:28
Michael Palmerie Jr.
TOWN CLERK

Town Council Meeting Minutes: ATESD Municipal Ordinance Approval

Prospect Town Council
January 8, 2026
Special Meeting
Approved Minutes

Chairman Michael Palmerie Jr. called to order the Special Meeting of the Prospect Town Council @ 8:24 p.m. The meeting was in person at the Prospect Town Hall. The meeting began with the Pledge of Allegiance.

Organizer of Meeting Present: M. Palmerie Jr. A call for attendance was taken by Chairman Michael Palmerie Jr.
Council Members Present: Mike Palmerie Jr., Rich Blanc, Stan Pilat, Scott Martin, Christina Inzitari, Loreen Elbakry, Jessica Hughes
Council Members Absent: Roger Sherman Jr., Chaka Felder
Others Present: Mayor Robert Chatfield

Discussion and possible action on Automatic Traffic Enforcement Safety Devices and Property Tax Exemption for 100% Disabled Veterans

Motion made by R. Blanc, seconded by C. Inzitari to approve an Ordinance to install Automatic Traffic Enforcement Safety Devices in the Town or Prospect. J. Hughes stated that she prepared something to read into the record. It explained her hesitation on speed cameras. Some residents find it intrusive. At the same time, we do have a safety issue. She is prepared to vote in favor, and she would like to add something to this. She is asking fellow Council members if we can think about some of the revenue for these speed cameras being used for matching grant funds for the sidewalks. (see correspondence)

S. Pilat explained his previous questions. Can it be misused?

Lt. Abarzua understands their questions and concerns. Can it be used for the wrong purpose. He explained that these are Traffic Enforcement camera only and the Town owns the data.

S. Martin stated that he has the same concerns as Jessica and others. Prospect is certainly a passthrough community. He agrees that 1 death is 1 too many. He is also concerned about the "almost". It's not perfect but something has to be done, and the Council asked for something to be done. The "almost" accidents are unacceptable. If the cameras are taking a picture of the license plate and not people, he accepts that. His concern is the people coming through our town that are speeding and putting lives in danger.

R. Blanc 1000% agrees with this. So many people are asking for them in their neighborhoods per Lt. Abarzua

J. Hughes mentioned using funds towards the sidewalk matching funds. She asked how the fellow Council members feel about that. S. Pilat stated he is in favor of anything that decreases the budget.

M. Palmerie agrees with S. Pilat as well as S. Martin. If we could save 1 life in Prospect, he would vote for that.

Roll call: All in favor. **Motion passed unanimously.**

Motion made by R. Blanc, seconded by L. Elbakry to approve the Ordinance for the Tax Abatement for 100% Disabled Veterans legal spouse.

Roll call: all in favor. Motion passed unanimously.

Appointments:

M. Palmerie read into the record a letter from the PRTC appointing Galen Lowenbaum, to the Library Board as well as Reappointing Sue McKernan and Carole Moschella to the Library Board.

Motion made by S. Martin, seconded by J. Hughes to approve the nominations of Galen Lowenbaum, Sue McKernan and Carole Moschella to the Library Board. **Unanimous.**

Meeting Dates

The Mayor stated the next meeting is the day after MLK day. He would like to move it to the last Tuesday of the month. January 27th instead of January 20th.

Motion made by C. Inzitari, seconded by S. Martin to cancel the January 20th Regular Town Council Meeting. **Unanimous.**

Motion made by C. Inzitari, seconded by S. Martin to move the Regular Meeting to January 27th at 7 p.m. **Unanimous.**

Correspondence:

Agenda, Traffic Enforcement packet, Legal Notice, Jessicas Hughes letter.

Motion made by S. Martin, seconded by R. Blanc to accept the correspondence and place on file. **Unanimous.**

Adjournment:

Motion made by R. Blanc, seconded by S. Pilat to adjourn the meeting at 8:44 p.m. **Unanimous.**

Michael Palmerie Jr.

Town Council Chairman

PROSPECT HORN
TOWN CLERK'S OFFICE
2026 FEB -4 AM 8:33
Carole Moschella
TOWN CLERK

Town Council Meeting Agenda: DOT ATESD Permit Application



TOWN COUNCIL • TOWN OF PROSPECT, CT 06712-1699
36 CENTER STREET (203) 758-4461

Town Council Regular Meeting Tuesday, February 17, 2026, at 7:00 p.m. Amended Agenda

This meeting is in person at Prospect *Town Hall*, 36 Center Street, lower-level conference room.

Call Meeting to Order

Pledge

Attendance

Guests

Mayor's Report

- Transfer(s)

Chair's Report

- **Speed Enforcement Program: DOT Application Discussion and Possible Action**

Approval of Minutes:

- January 27, 2025, Regular Meeting
- February 3, 2026, Regular Meeting
- February 11, 2026, Special Meeting

New Business

- Refunds
- Resignations
- Appointments
- Bids/Grants

Old Business

Subcommittees

Land Use & Acquisition, Sidewalk Task Force, Pension, Ordinance, Salary Review, Town Buildings

- **Public Comments** (3 Minute Time Limit)
- **Council Comments**

Correspondence & Action on correspondence

Adjournment

Mike Palmerie,

Town Council Chairman

Mike Palmerie
TOWN CLERK
2026 FEB 13 PM 3:10
TOWN OF PROSPECT, CT



Town Council Meeting Minutes: DOT ATESD Permit Application Approval

Prospect Town Council
February 17, 2026
Regular Meeting
Unapproved Minutes

Chairman Michael Palmerie Jr. called to order the Regular Meeting of the Prospect Town Council @ 7:00 p.m. The meeting was in person at the Prospect Town Hall. The meeting began with the Pledge of Allegiance.

Organizer of Meeting Present: M. Palmerie Jr. A call for attendance was taken by Chairman Michael Palmerie Jr.
Council Members Present: Mike Palmerie Jr., Roger Sherman Jr., Rich Blanc, Stan Pilat, Scott Martin, Christina Inzitari, Loreen Elbakry (7:01 p.m.), Chaka Felder (7:07 p.m.), Jessica Hughes
Council Members Absent: none
Others Present: Mayor Robert Chatfield

Chair's Report

- **Speed Enforcement Program: DOT Application Discussion and Possible Action**

Lt. Nelson Abarzua explained they are looking for approval to move forward with the application and send it to CT DOT.

Motion made by R. Blanc, seconded by C. Inzitari to Authorize the Prospect Police Dept. to move forward with submitting the Application for the Speed Enforcement Program to the CT DOT for approval.

J. Hughes asked for an explanation about the 85% threshold in the statistics in the study. What does that mean? Sgt. Jason Carrier stated that it is his understanding that the company they are working with uses that 85% to verify viable locations where they will get the number of speeders that will be beneficial to the program. They did get some pushback on one location. They will present that location to the CT DOT explaining that is a very important location based on what they have seen. If the DOT does deny a site they can make an amendment to the application.

Lt. Abarzua referred to Rt. 68 coming in from Cheshire. The camera will be around Skrip's Auto. They asked to move the signage prior to Cook Road to slow traffic up before they get there.

R. Sherman mentioned sign prior to Cook Road from Cheshire to slow traffic up before Cook Road.

(Chaka Felder arrived at 7:07 p.m.)

Motion passed unanimously.

Mayor's Report

- The Mayor stated they swore in a new Police Officer today, Kenneth Ventresca.
- They will start street sweeping soon if no other storms
- The Mayor stated he will have an updated 6-month Financial Spreadsheet to submit at the next meeting. Anne was away and just got back today.

- February 3, 2026, Regular Meeting
Motion made by R. Blanc, seconded by L. Elbakry to approve the February 3, 2026, Regular Meeting minutes. **Unanimous.**
- February 11, 2026, Special Meeting.
Motion made by R. Blanc, seconded by L. Elbakry to approve the February 11, 2026, Special Meeting minutes. **Unanimous.**

New Business

- **Refunds**
Motion made by R. Sherman, seconded by C. Inzitari to approve the 3 Tax Refunds for a total of \$325.39. **Unanimous.**
- **Resignations:** none
- **Appointments:**
M. Palmerie referred to 2 letters. 1 from the Democratic Town Committee and 1 from the Republican Town Committee listing board and commission members who need their terms renewed.
Motion made by J. Hughes, seconded by R. Sherman, to approve the new terms for all the members on the 2 letters presented to the Council tonight. (See correspondence). **Unanimous.**
- **Bids/Grants:** M. Palmerie mentioned the Grant's Writer Report. S. Martin wanted to clarify that he thought before we apply for any grants, it needs to come before the Town Council first. J. Hughes thought it was only if there is a match or cost to the Town. The Council discussed that the information from the Grants Writer says "potential" grant opportunities. They have not yet been applied for. M. Palmerie will clarify with M. Patchkofsky.
- L. Elbakry asked if the Grants Writer will be attending next meeting to talk about the waterline extension grant after she meets with the Senator's office. M. Palmerie will ask her to join.
- M. Palmerie referred to a transfer request from the Registrar of Voters:

Transfer from:		Transfer to:	
Account name:	General Fund	Account name:	Election Workers/Deputies
Account Number:		Account Number:	5150-01
Amount:	\$446.76		
Reason for request:	Reimbursement from Region 16 for 12/2025 referendum		

Motion made by R. Sherman, seconded by C. Inzitari to approve for discussion the above transfer in the amount of \$446.76 from the Registrars of Voters.

L. Elbakry asked for clarification. Are these additional funds needed after the last transfer request from Registrars of Voters or was this included in that. The Council would like clarification.

All opposed. Motion denied.

Old Business: none

Subcommittees:

- **Land Use & Acquisition-** S. Martin will have more info. on the open item at the second regular meeting in March.
- **Sidewalk Task Force-** none
- **Pension-** The Mayor stated we will need to have a meeting; Pension is very outdated.
- **Ordinance-** none
- **Salary Review-** none
- **Town Buildings-** none

L. Elbakry asked about the Economic Development Committee.

Public Comments: (3-Minute Time Limit) none

Council Comments:

- M. Palmerie asked the Mayor in the Public Works monthly report, if they can add a column that would list repairs as well as tires.

Correspondence:

Agenda, Minutes, 2-Transfer, Refunds, Reports: Fire Dept., Police Dept., Town Clerk, Treasurer, Tax Collector, Grants Director, Fire Marshal, Democratic and Republican expired terms letters, Police Dept. new hire.

Motion made by R. Sherman, seconded by S. Pilat to accept the correspondence and place on file. **Unanimous.**

Adjournment:

Motion made by R. Blanc, seconded by C. Inzitari to adjourn the meeting at 7:28 p.m. **Unanimous.**

Michael Palmerie Jr.
Town Council Chairman

Michael Palmerie Jr.
TOWN CLERK
2026 FEB 18 AM 8:28
TOWN CLERK JOHN
CIVIL CLERK JEFFREY

D. Municipal Safety Action Plan

Regional Transportation Safety Plan: Prospect, CT

Reference this [link](#) for the complete [Naugatuck Valley Regional Transportation Safety Plan](#).

TOWN OF PROSPECT

2016 US Census Population Estimate: 9,755
Area: 14.50 square miles
Population Density: 673 persons per square mile
2016 Vehicle Miles Traveled (VMT): 53,521,045
2016 VMT per Capita: 5,487
Setting: Rural
Town and Regional Representatives: Robert J. Chatfield (Mayor), Lt. Nelson J. Abaruzza (Director of Public Safety)
Data Identified High Crash Corridors: N/A
Data Identified High Crash Intersections: N/A
Bike and Ped Injury and Fatal Crash Injuries: 4
Total Number of Crashes Involving Injuries or Fatalities, 2015-2018: 207

Overview

Prospect is a rural town located at the highest elevation in New Haven County, bordered by Waterbury to the north, Bethany to the south, Naugatuck to the west, and Cheshire to the east. The town's main thoroughfares are CT-42, CT-68, and CT-69.

Town Input

Fatal Crashes from 2015-2018

- Talmadge Hill Road and CT-68 (Cheshire Road) - Young driver, multi-car, angle crash resulting in one fatality.
- CT-68 (Union City Road) near Laura Avenue - Front-to-front lane departure fatal crash.
- Summit Road - Substance-involved roadway departure fatal crash.
- CT-69 (Waterbury Road) - Young driver lane departure fatal crash.



Talmadge Road

CT-68 (Cheshire Road)/Matthew Street/Talmadge Hill Road CT-68 (Cheshire Road)/Matthew Street/Talmadge Hill Road

This is a two-way stop-controlled intersection with sight distance issues from the local side streets. CT-68 (Cheshire Road) has vertical curvature that extends from Prospect east to Cheshire, and the speed limit is posted at 45 MPH. A crest in the roadway on CT-68 (Cheshire Road), just north of this intersection, limits the sight distance and the stopping time due to high speeds. There is a utility pole at Talmadge Hill Road and CT-68 (Cheshire Road) that is in the line of sight. The town installed stop ahead warning signs and pavement markings on Matthew Street and Talmadge Hill Road to alert drivers. This intersection is a site of a recent fatal crash.

Edge Line Pavement Markings

The Town of Prospect installed edge lines on most of their roads to help mitigate roadway departure crashes.

Summit Road and Peter Gilkey Road

This intersection had numerous crashes over the years. There is a steep downgrade into a horizontal curve at the unsignalized intersection. The geometry of the intersection can confuse the motorists travelling north-bound on Summit Road, drawing them into Gilkey Road instead of keeping them on Summit Road through the horizontal curve.

CT-69 (Waterbury Road)

The town requested the state move the merge lane on CT-69 (Waterbury Road) farther north due to a concentration of crashes occurring at the previous merge location, in front of Oliver's Supermarket (closer to the Town Center), which the state did. The Town stated that the crash frequency has been reduced significantly since the state redesigned the merge lane.

Regional Middle School District

The middle school located behind the town hall on Center Street serves multiple towns and has a high percentage of students who use parent drop-off instead of school busses, resulting in congestion during the AM period.

Motorcycles

The town has had some issues with motorcycles speeding on CT-69 (Waterbury Road/New Haven Road).

Signs on CT-42 (Mountain Road)

The state repaved CT-42 (Mountain Road). The Town of Prospect border signs were not reinstalled in the correct locations; they are too far east into Cheshire. This has caused emergency response issues because there has been some confusion as to which town is responsible. The town wants the state to relocate signs at town lines.

Center Line Rumbles

The town has rumble strips on Straitsville Road and Scott Road. They would like them on CT-68 (Union City Road/Cheshire Road) and CT-69 (Waterbury Road/New Haven Road) and Summit Road as well.

Chevron Curve Signs

CTDOT is installing chevron curve signs along CT-68 (Cheshire Road) east of Roaring Brook Road where there have been a series of crashes.

Dynamic Speed Feedback Signs

The town employs these signs on various roadways. Some of them are permanently mounted, and some are transferable and collect various traffic data.

Pedestrians

The Town of Prospect is using a LOTCIP grant to fund sidewalks on the west side of CT-69 (Waterbury Road) from the Center of Town to Hotchkiss Fields. In addition, they will be upgrading the current pedestrian crossings with ADA compliant ramps and pedestrian signals at CT-68 (Union City Road/Cheshire Road) and CT-69 (Waterbury Road/New Haven Road).

Bicycles

CT-69 (Waterbury Road/New Haven Road) and Straitsville Road in Prospect are used as a training route for cyclists in the warmer months. The intersection at CT-69 (New Haven Road) and Lee Road is of concern to cyclists since some have been hit there before due to the crest on CT-69 (New Haven Road).

Prospect Total Crashes by Severity

Crash Severity	2015	2016	2017	2018
Fatal Injury (K)	0	1	1	2
Suspected Serious Injury (A)	2	1	0	0
Suspected Minor Injury (B)	22	31	21	12
Possible Injury (C)	30	26	26	32
Total Crashes	54	59	48	46

Prospect Crash Map

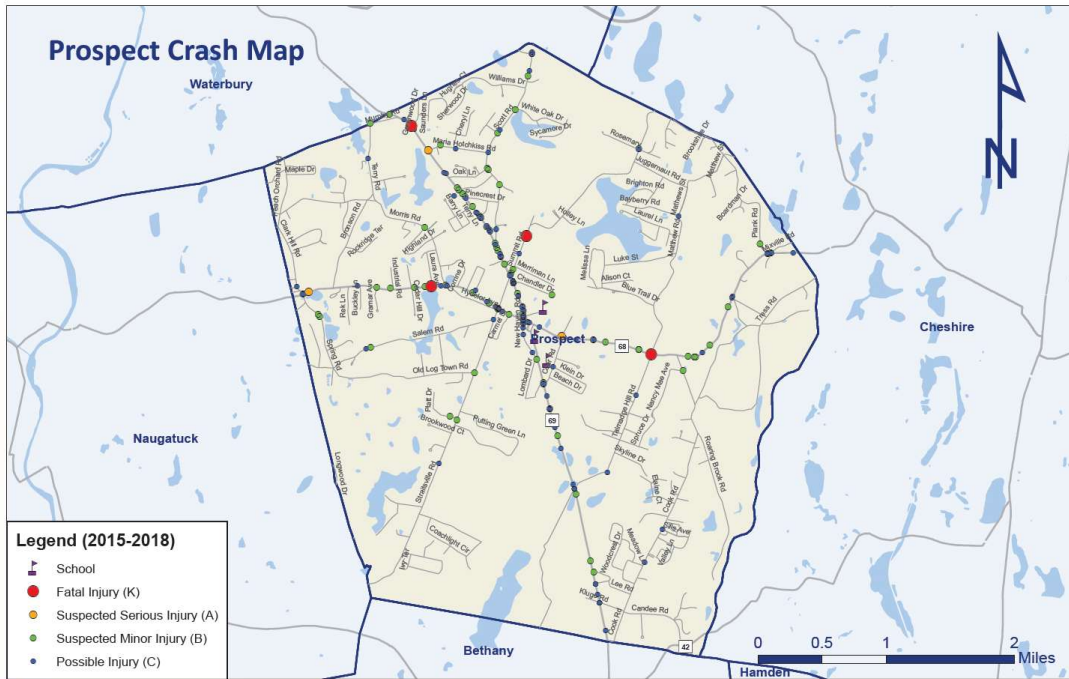

Field Site Inventory

CT-68 (Cheshire Road)/Talmadge Hill Road/Matthew Road

This is a two-way intersection with a stop control at the Talmadge Hill Road and Matthew Road approaches. Stop pavement markings are present. The vegetation is managed on CT-68 (Cheshire Road); trees have been cut down recently. The crest on CT-68 (Cheshire Road) impedes the sight distance for the motorists heading east towards Cheshire from both side of the streets. The utility pole on the southeast corner is in the line of sight for the motorists on Talmadge Hill Road. There is a vertical curvature downslope for eastbound traffic. The CT-68 (Cheshire Road) speed limit is posted at 45 MPH, but the motorists travel at higher speeds.

Recommendations:

- Lower crest on CT-68 (Cheshire Road).
- Continue to manage vegetation.
- Install Dynamic Speed Feedback signs on CT-68 (Cheshire Road).

Summit Road/Peter Gilkey Road

The intersection of Summit Road and Peter Gilkey Road is a skewed, three-way, unsignalized intersection within a residential neighborhood with Summit Road as the mainline. Peter Gilkey Road is a dead-end road servicing four houses and is under stop control at Summit Road. Summit Road runs north/south as the main movement with a posted speed limit of 25 MPH. The Summit Road northbound approaches the intersection on a steep downgrade and into a sharp horizontal curve to the right beginning at the intersection. Due to the sharp horizontal curve, northbound motorists can be confused and continue straight onto Peter Gilkey Road crossing on-coming traffic. Antiquated warning and chevron signs are present on the northbound approach to alert motorists of the upcoming conditions.

Recommendations:

- Consider adding additional chevron signs and upgrading the warning signs with retroreflective signs and retroreflective sign-post strips.
- Consider reducing the width of the Peter Gilkey Road approach and better align it with Summit Road to address the skew.



Talmadge Hill Rd/Matthew Rd/ CT-68 (Cheshire Rd)



Summit Rd/Peter Gilkey Rd

Prospect Countermeasure Considerations

Locations	Issues	Countermeasures	Estimated Cost
CT-68 (Cheshire Road)/Talmadge Hill Road/Matthew Road	Frequent site of angle crashes	Lower crest on CT-68 (Cheshire Road).	Medium
		Continue to manage vegetation.	Low
		Install Dynamic Speed Feedback signs on CT-68 (Cheshire Road)	Low
Summit Road/Peter Gilkey Road	Older chevron signs along horizontal curve	Add additional chevron signs and upgrading the warning signs with retroreflective signs and retroreflective sign-post strips.	Low
	Skewed intersection	Reduce the width of the Peter Gilkey Road approach and better align with Summit Road	Low
	Confusing roadway geometry	Reduce the Peter Gilkey Road approach cross section, additional chevrons can be installed in better line of sight for Summit Road northbound motorists.	Low
CT-42 (Mountain Road)	Town signs are not at town lines	Ask state to relocate signs along CT-42 on the town line	Medium
Various roadways (CT-68, CT-69 and Summit Rd)	Roadway departure crashes	Install centerline rumble strips	Low
Townwide	Motorcycle Crashes	Motorcycle education and outreach in local papers	Low
	Pedestrians	Install sidewalks	Low
	Bicycles	Sharrows and Share the Road signs	Low
	General Safety	Use variable message signs to alert motorists to pedestrians, bicyclists and motorcycles	Medium

E. General Municipal Data

i. Number of Traffic Stops Conducted

Year	Traffic Stops
2023	127
2024	183
2025	136
Total	446

ii. Equity Data

Poverty Rate: **1.2%**

% of Occupied Housing Units with Vehicles: **98.6%**

Prospect municipal data in [U.S. Census Bureau's recent American Community Survey](#).

iii. Qualified Census Tract Identification

The Town of Prospect is located in New Haven County. Per the US Department of Housing and Urban Development there are zero (0) Qualified Census Tracts located within the Town of Prospect.

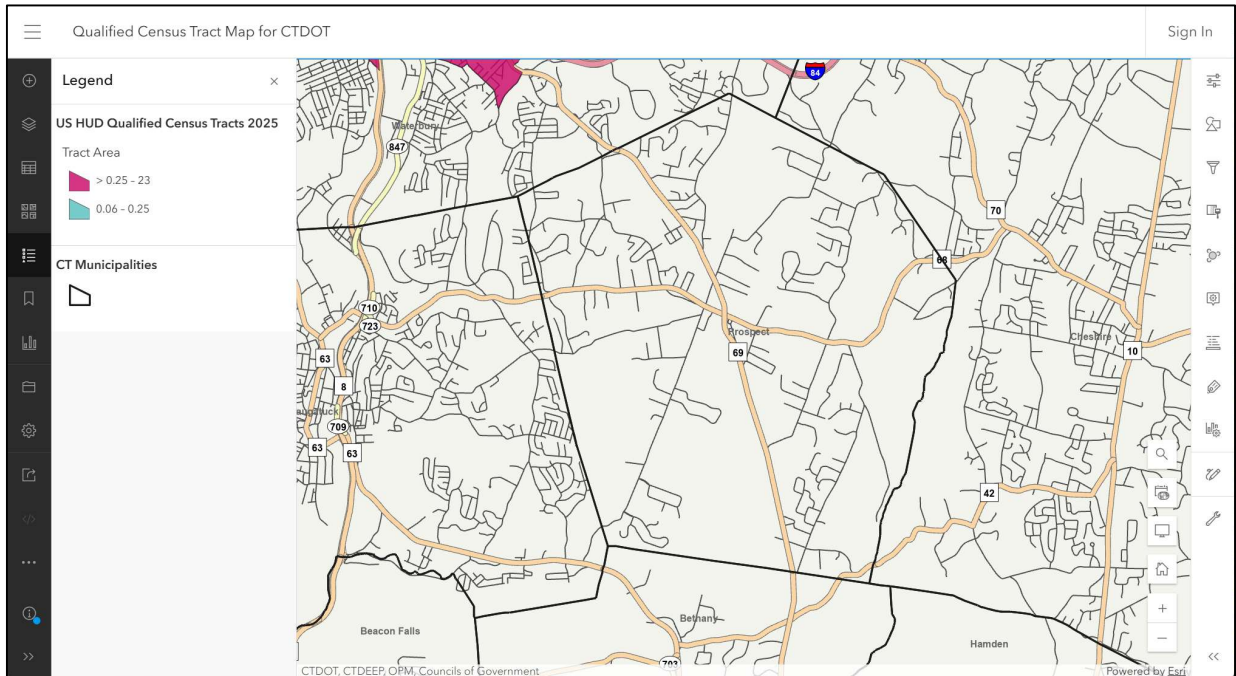

***Per <https://ctdot.maps.arcgis.com/apps/mapviewer/index.html?webmap=50eb6d797a9a4850894354520a8428ac>

PROPOSED ATESD SPEED CAMERA SITES

1. Waterbury Rd (SR-69) South of Oak Ln

a. Site Selection Justification

Waterbury Road (SR-69) south of Oak Lane is a proposed bi-directional ATESD location on a 35-mph three-lane undivided minor highway running north–south through the town center. This corridor carries an Average Daily Traffic volume of 9,000 vehicles and serves a mixed commercial and residential area with high driveway and intersection density. The site was selected to address sustained excessive speeding that is inconsistent with the roadway’s access frequency and community setting.

The roadway consists of two southbound lanes and one northbound lane with narrow shoulders and limited recovery area. Commercial businesses line the west side of the corridor, while multiple residential streets intersect from the east, creating frequent turning movements and conflict points. Visibility at intersections and driveways is restricted by tree and brush cover, reducing available reaction time and increasing crash risk at higher operating speeds. Despite ongoing enforcement efforts, the roadway geometry and traffic volume limit the effectiveness of sustained officer-based speed control.

The corridor is in proximity to Hotchkiss Field, which contributes to pedestrian activity and peak-period traffic surges associated with recreational use. Crash history, including speed-related incidents and severe outcomes, demonstrates an ongoing safety concern. Local enforcement resources are limited relative to corridor demand, requiring alternative methods to support a comprehensive traffic safety strategy. Deployment of an Automated Traffic Enforcement Safety Device at this location is intended to promote sustained speed compliance, reduce crash risk, and improve safety for motorists, pedestrians, and adjacent land uses within the town center.

b. Roadway Image of Site w/ Signage Location

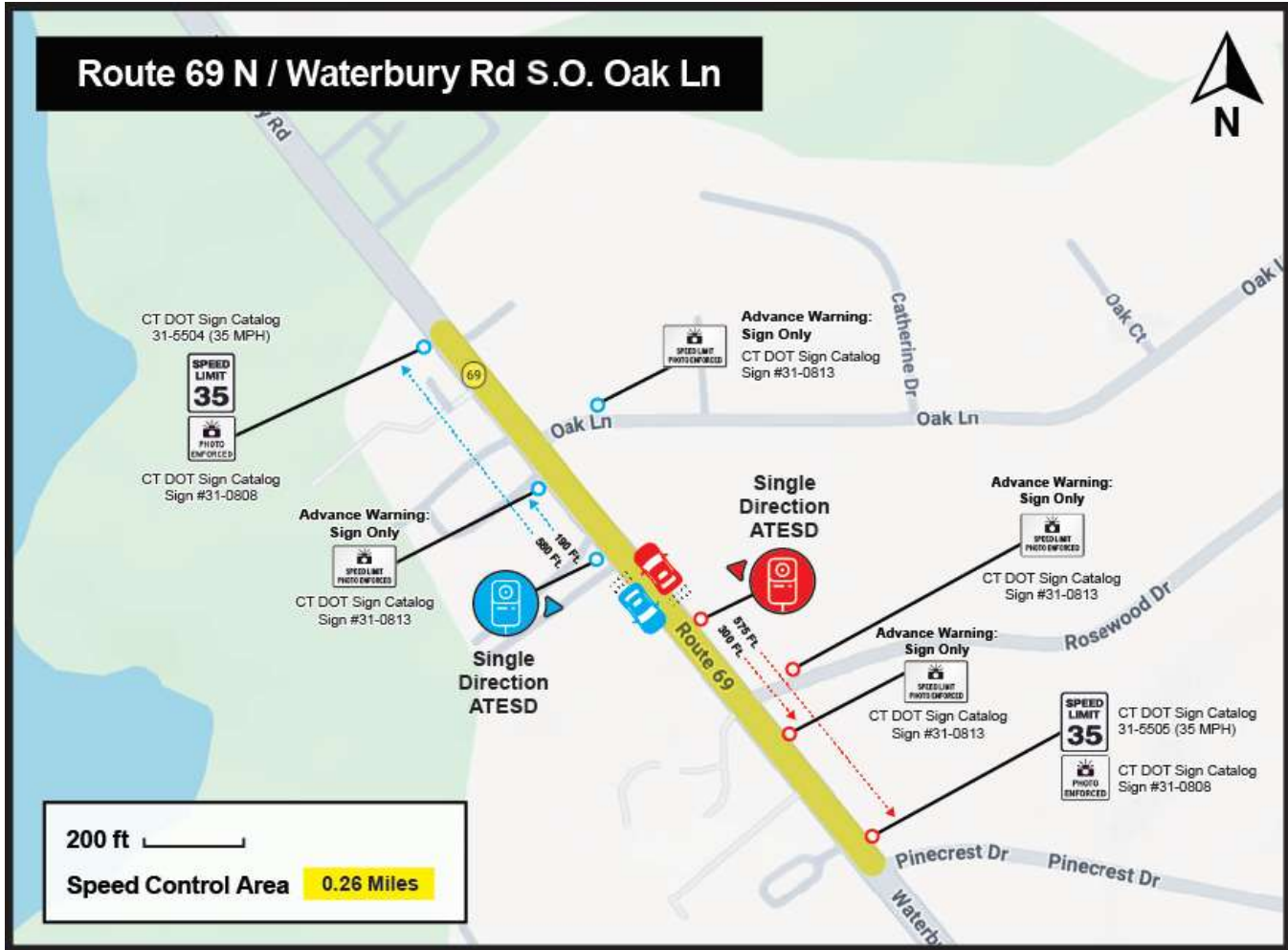

Pole and camera overlay above are for illustrative purposes only and are not to scale



Pole and camera overlay above are for illustrative purposes only and are not to scale

ATESD permit created with technical assistance from DacraTech - www.dacratech.com - 847.490.8440

c. Site Selection Data

i. Average Daily Traffic Counts by Speed

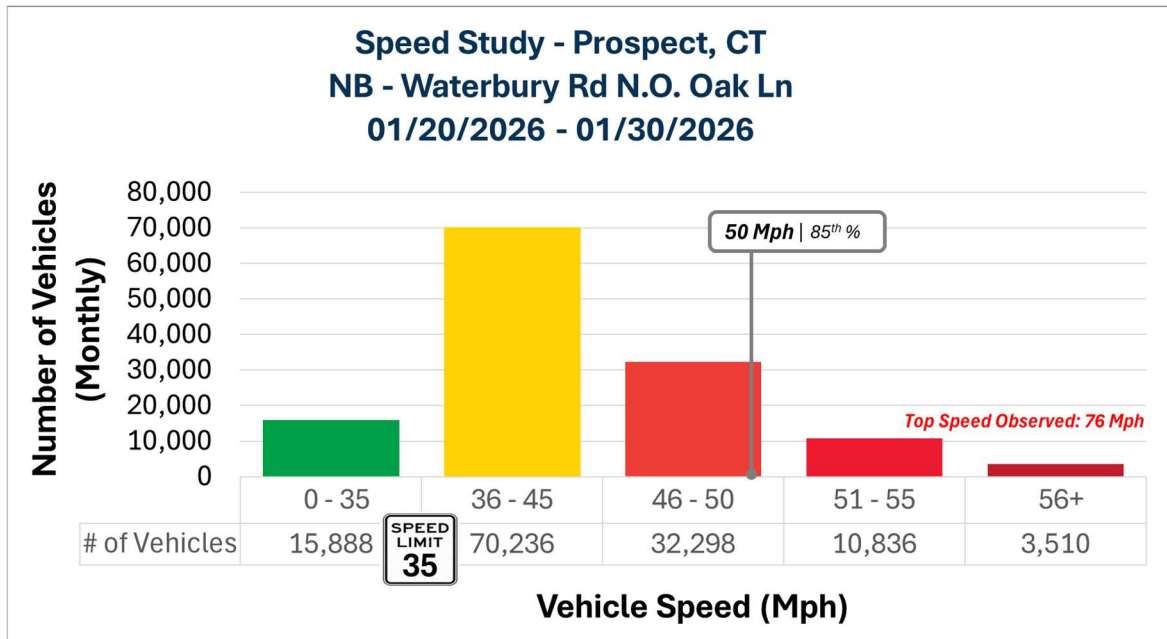

Speed (Mph)	Average Traffic				% of All Traffic	
	Daily		Monthly			
56+	117.0		3,510.0		2.6%	
51 - 55	361.2	1,555	10,836.0	46,644	8.2%	35.1%
46 - 50	1,076.6		32,298.0		24.3%	
36 - 45	2,341.2	2,341	70,236.0	70,236	52.9%	52.9%
0 - 35	529.6	530	15,888.0	15,888	12.0%	12.0%
Total	4,426		132,768		100%	

Data Source: All Traffic Data Services for TYLin (01/20/26 - 01/30/26)
 Study includes 5 days of data (1/20, 1/21, 1/28 - 1/30)

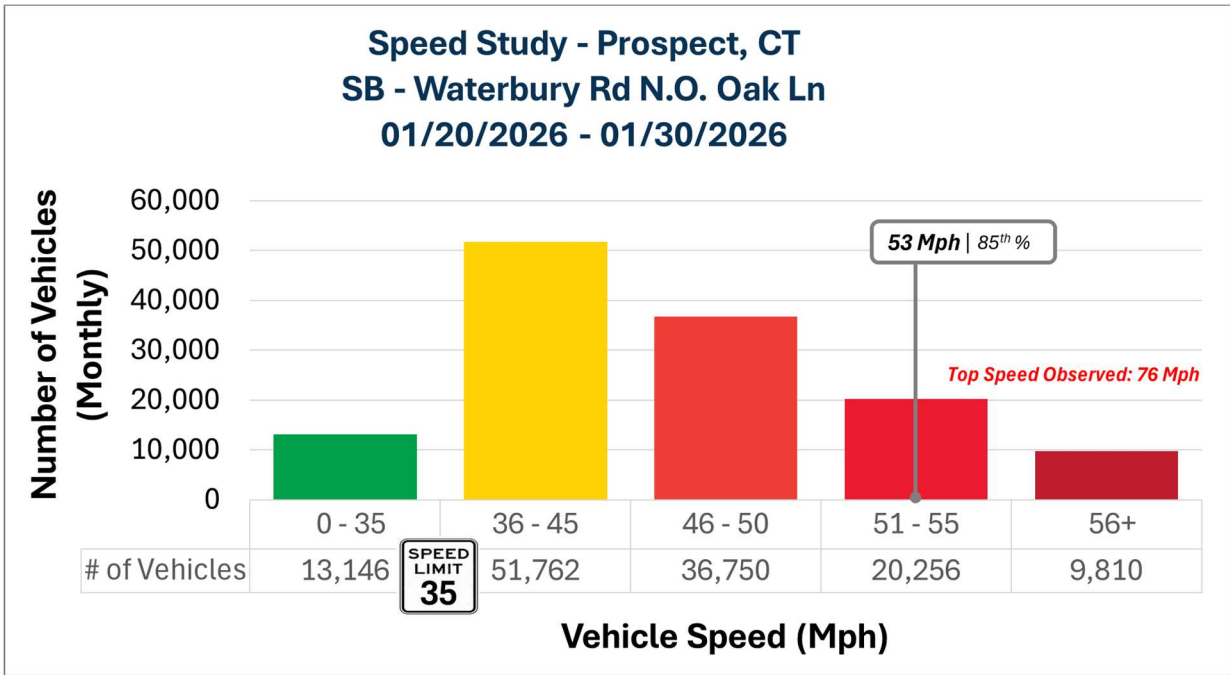

Speed (Mph)	Average Traffic				% of All Traffic	
	Daily		Monthly			
56+	327.0		9,810.0		7.4%	
51 - 55	675.2	2,227	20,256.0	66,816	15.4%	50.7%
46 - 50	1,225.0		36,750.0		27.9%	
36 - 45	1,725.4	1,725	51,762.0	51,762	39.3%	39.3%
0 - 35	438.2	438	13,146.0	13,146	10.0%	10.0%
Total	4,391		131,724		100%	

Data Source: All Traffic Data Services for TYLin (01/20/26 - 01/30/26)
Study includes 5 days of data (1/20, 1/21, 1/28 - 1/30)

ii. Site Crash History

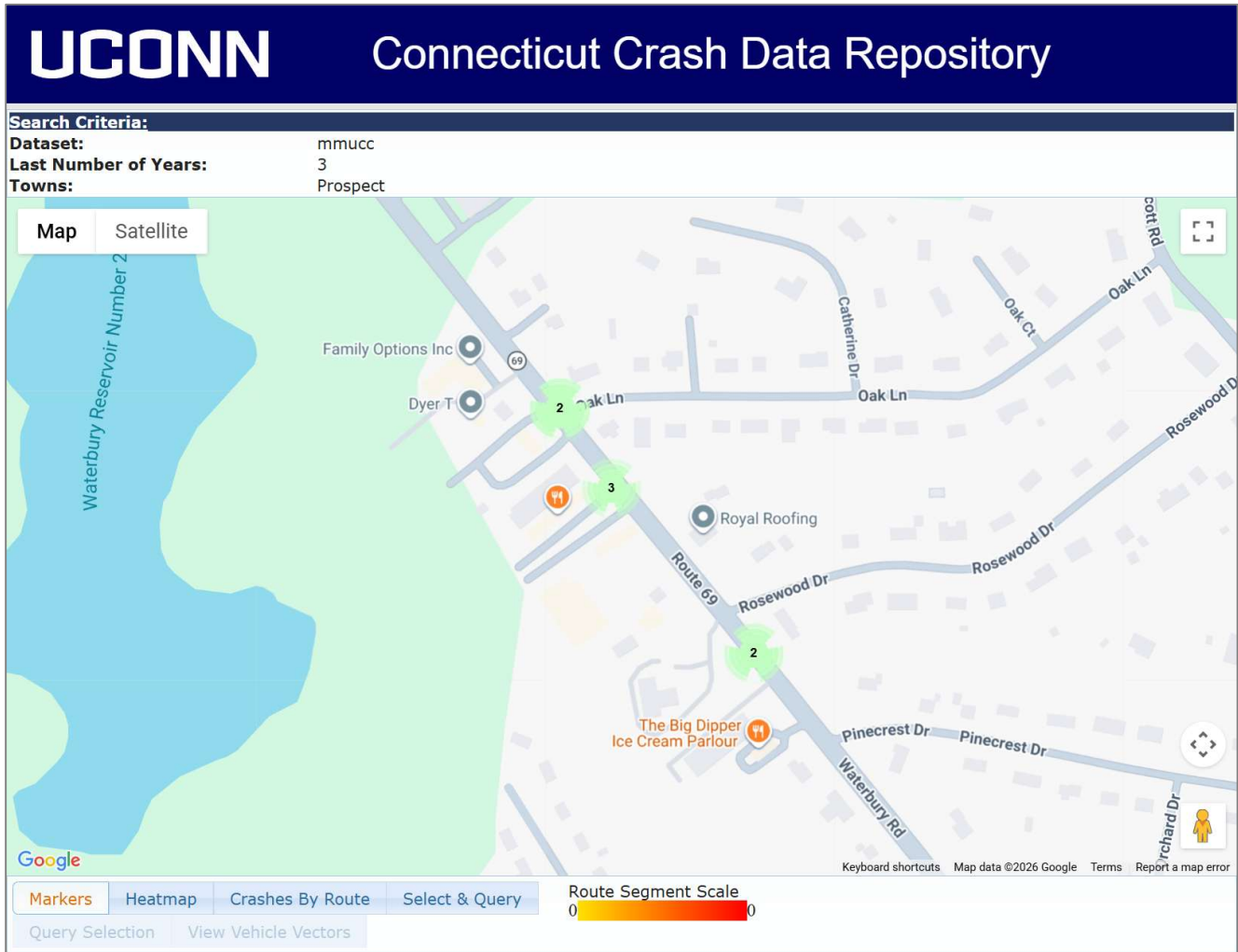

#	CrashId	Town Name	Date Of Crash	Crash Severity	Milemarker	Roadway Name	Intersecting Roadway Name
1	1018481	Prospect	1/5/2023	Injury of any type (Serious, Minor, Possible)	13.27	69-N	null
2	1034685	Prospect	3/7/2023	Property Damage Only	13.31	69-N	null
3	1058546	Prospect	6/9/2023	Injury of any type (Serious, Minor, Possible)	13.25	69-N	null
4	1068697	Prospect	7/17/2023	Property Damage Only	13.18	69-N	ROSEWOOD DR
5	1111688	Prospect	12/8/2023	Property Damage Only	13.16	69-N	null
6	1169811	Prospect	6/20/2024	Property Damage Only	13.27	69-N	null
7	1255059	Prospect	3/7/2025	Property Damage Only	13.31	69-N	OAK LA

2. New Haven Rd. (SR-69) North of Talmadge Hill Rd

a. Site Selection Justification

New Haven Road (SR-69) north of Talmadge Hill Road is a proposed bi-directional ATESD location on a 45-mph two-lane undivided minor highway. This segment carries an Average Daily Traffic volume of 10,000 vehicles and serves as a primary north–south connector. The site was selected to address excessive approach speeds in advance of the Talmadge Hill Road intersection, where speed reduction is necessary to reduce conflict risk.

The corridor is characterized by narrow shoulders and heavy tree cover along both sides of the roadway, which restricts space and sight distance. These conditions increase crash severity potential and reduce driver reaction time, particularly at higher operating speeds. Traditional traffic enforcement cannot be safely conducted in the southbound direction due to the lack of adequate shoulder width, limiting the ability to maintain consistent officer-based speed control.

The corridor is in proximity to Prospect Elementary School and recreational facilities at Caplan and Fusco Field, both of which contribute to peak-period traffic surges and increased opportunity for conflict. Documented crash history, including fatal and speed-related incidents, reinforces the presence of an ongoing safety concern. Local enforcement limitations necessitate alternative measures to support a comprehensive traffic safety strategy.

Deployment of an Automated Traffic Enforcement Safety Device at this location is intended to achieve sustained speed compliance, reduce crash risk at the Talmadge Hill Road intersection, and improve safety for motorists, pedestrians, and nearby community users.

b. Roadway Image of Site w/ Signage Location



Pole and camera overlay above are for illustrative purposes only and are not to scale



Pole and camera overlay above are for illustrative purposes only and are not to scale

ATESD permit created with technical assistance from DacraTech - www.dacratech.com - 847.490.8440



c. Site Selection Data

i. Average Daily Traffic Counts by Speed

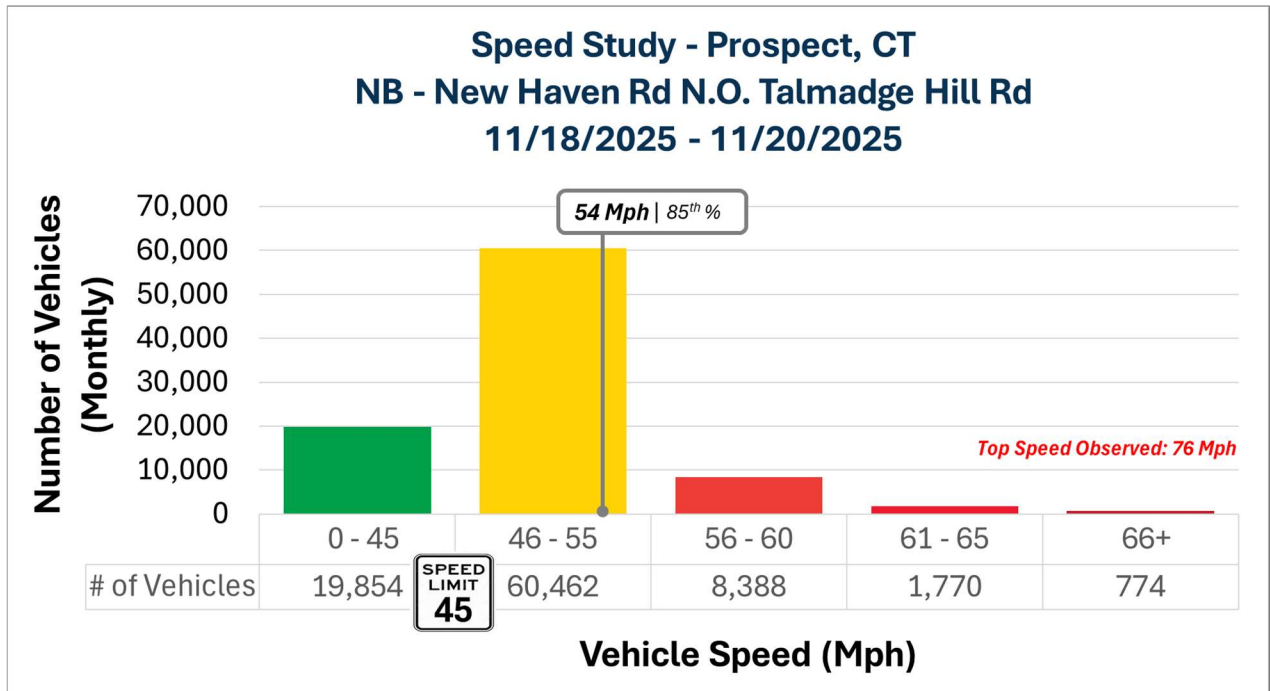

Speed (Mph)	Average Traffic		% of All Traffic	
	Daily	Monthly		
66+	25.8	774.0	0.8%	
61 - 65	59.0	1,770.0	1.9%	12.0%
56 - 60	279.6	8,388.0	9.2%	
46 - 55	2,015.4	60,462.0	66.3%	66.3%
0 - 45	661.8	19,854.0	21.8%	21.8%
Total	3,042	91,248	100%	

Data Source: All Traffic Data Services for TYLin (11/18/25 - 11/20/25)

Speed Study - Prospect, CT
SB - New Haven Rd N.O. Talmadge Hill Rd
11/18/2025 - 11/20/2025

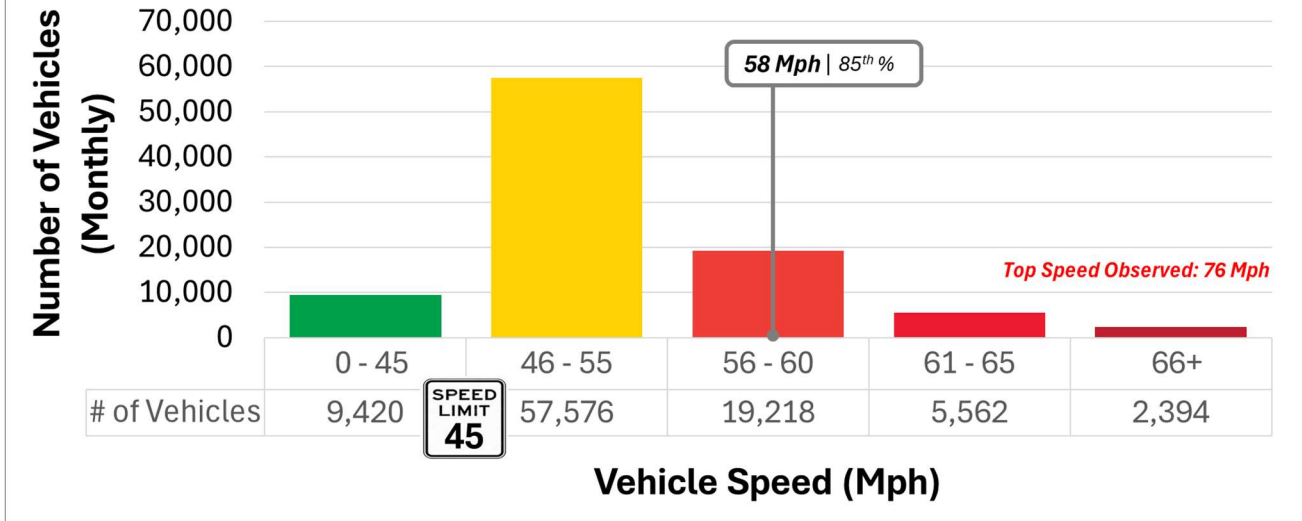

Speed (Mph)	Average Traffic				% of All Traffic	
	Daily		Monthly			
66+	79.8		2,394.0		2.5%	
61 - 65	185.4	906	5,562.0	27,174	5.9%	28.9%
56 - 60	640.6		19,218.0		20.4%	
46 - 55	1,919.2	1,919	57,576.0	57,576	61.1%	61.1%
0 - 45	314.0	314	9,420.0	9,420	10.0%	10.0%
Total		3,139		94,170		100%

Data Source: All Traffic Data Services for TYLin (11/18/25 - 11/20/25)

ii. Site Crash History

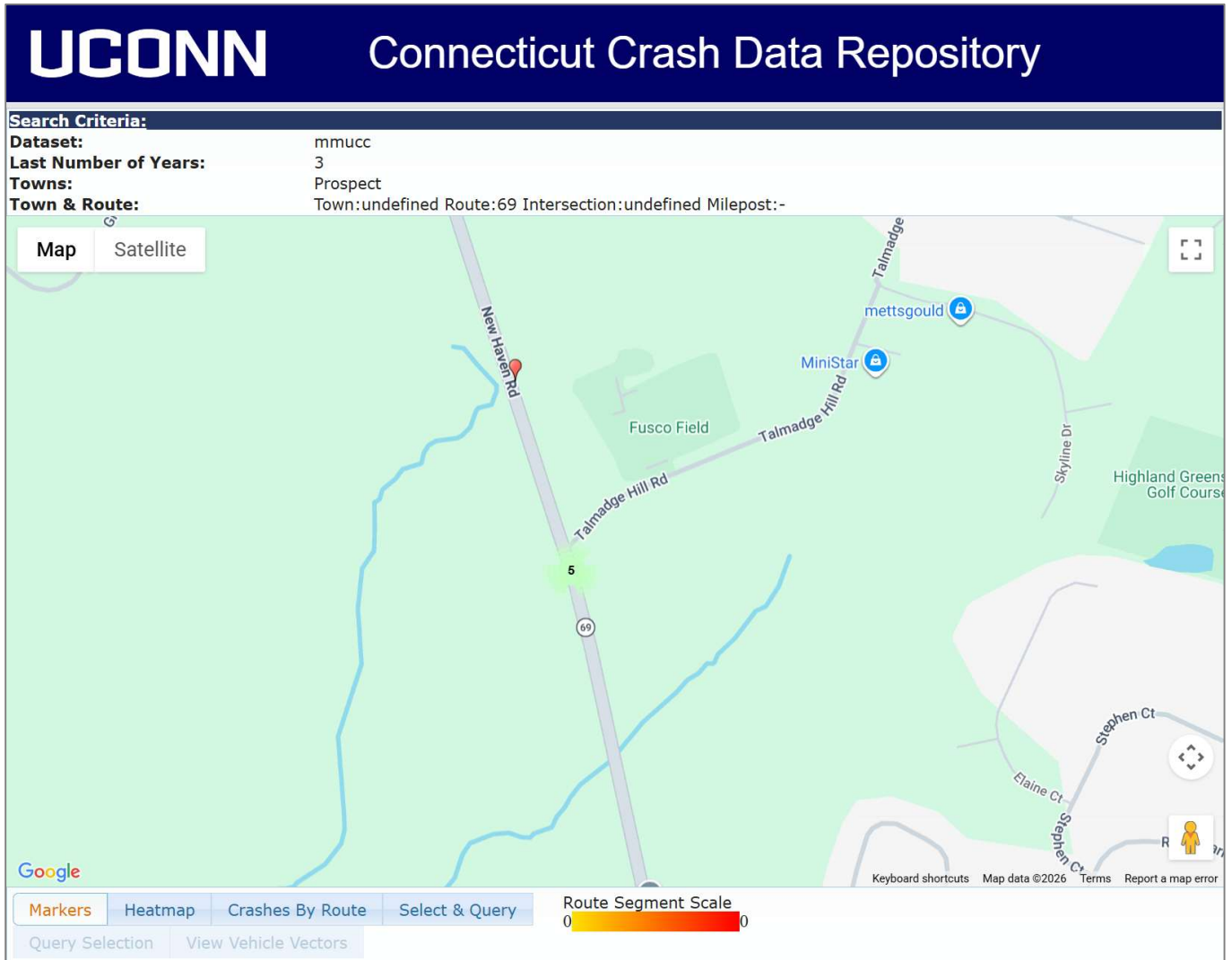

#	CrashId	Town Name	Date Of Crash	Crash Severity	Milemarker	Roadway Name	Intersecting Roadway Name
1	1041542	Prospect	4/7/2023	Injury of any type (Serious, Minor, Possible)	10.67	69-N	null
2	1053960	Prospect	5/26/2023	Injury of any type (Serious, Minor, Possible)	10.65	69-N	TALMADGE HILL RD
3	1056537	Prospect	5/20/2023	Injury of any type (Serious, Minor, Possible)	10.82	69-N	null
4	1227452	Prospect	12/10/2024	Injury of any type (Serious, Minor, Possible)	10.65	69-N	TALMADGE HILL RD
5	1262445	Prospect	3/14/2025	Property Damage Only	10.69	69-N	null
6	1322462	Prospect	10/16/2025	Fatal (Kill)	10.63	69-N	null

3. Cheshire Rd (SR-68) West of Matthew St

a. Site Selection Justification

Cheshire Road (SR-68) west of Matthew Street is a proposed bi-directional ATESD location on a 45-mph two-lane undivided minor highway. This segment carries an Average Daily Traffic volume of 8,000 vehicles and functions as a key east–west connector. The site was selected to address sustained excessive speeding in advance of high conflict intersections and a roadway segment with significant horizontal curvature and grade changes where high operating speeds substantially increase crash severity risk.

East of Matthew Road, the corridor includes pronounced bends and elevation changes that reduce sight distance and vehicle stability at higher speeds. These geometric constraints make speed control critical to maintaining safe operating conditions. Crash history, including fatal and speed-related incidents, reinforces the need for proactive speed management. Traditional traffic enforcement is constrained by limited shoulder width and roadway geometry, making sustained officer-based speed control difficult to implement.

Additional warning signage is proposed in advance of Cook Road and Matthew Road to increase compliance of posted speed limits ahead of high conflict intersections. Additional signage and ATSEDs support a targeted safety strategy focused on reducing approach speeds and improving driver compliance.

Deployment of an Automated Traffic Enforcement Safety Device at this location is intended to achieve sustained speed reduction, lower crash risk through the high-risk sections of this corridor and improve overall safety for roadway users.

b. Roadway Image of Site w/ Signage Location

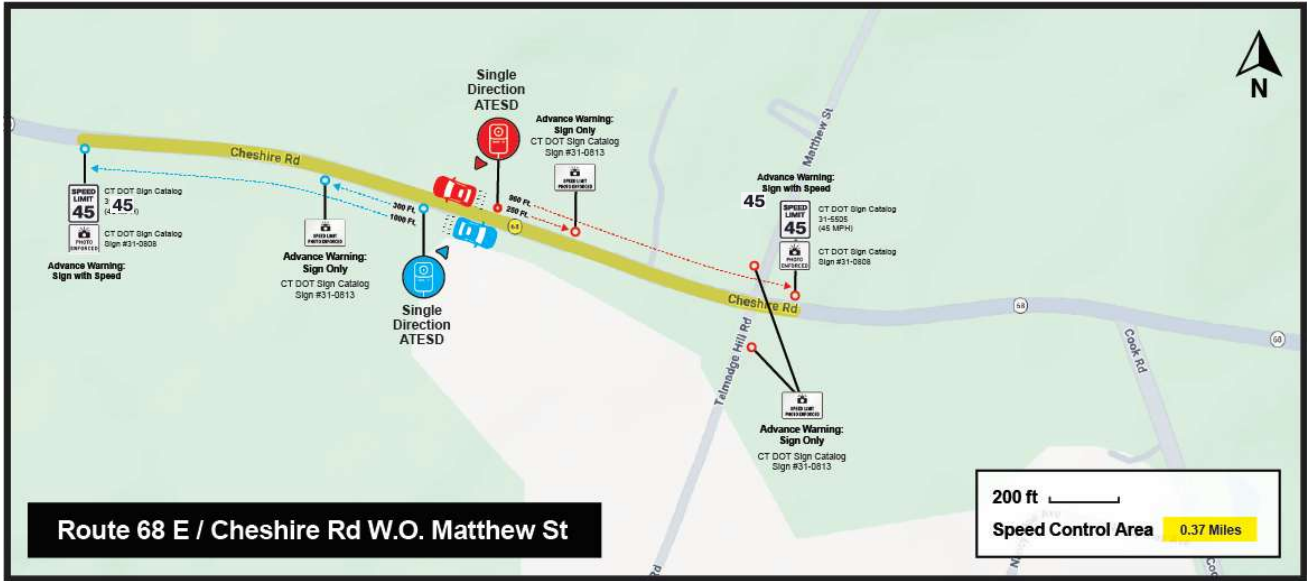

Pole and camera overlay above are for illustrative purposes only and are not to scale



Pole and camera overlay above are for illustrative purposes only and are not to scale

ATESD permit created with technical assistance from DacraTech - www.dacratech.com - 847.490.8440

c. Site Selection Data

i. Average Daily Traffic Counts by Speed

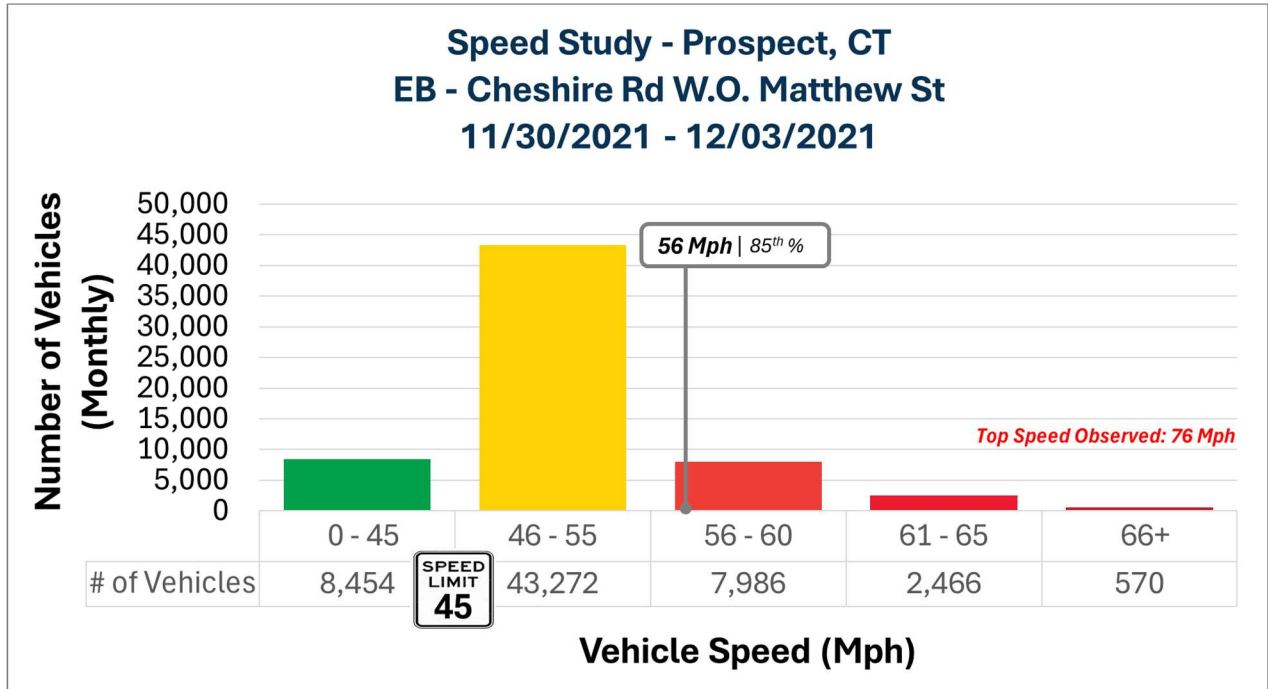

Speed (Mph)	Average Traffic		% of All Traffic
	Daily	Monthly	
66+	19.0	570.0	0.9%
61 - 65	82.2	2,466.0	3.9%
56 - 60	266.2	7,986.0	12.7%
46 - 55	1,442.4	43,272.0	69.0%
0 - 45	281.8	8,454.0	13.5%
Total	2,092	62,748	100%

Data Source: CT DOT Traffic Monitoring (11/30/21 - 12/03/21)

Speed Study - Prospect, CT
WB - Cheshire Rd W.O. Matthew St
11/30/2021 - 12/03/2021

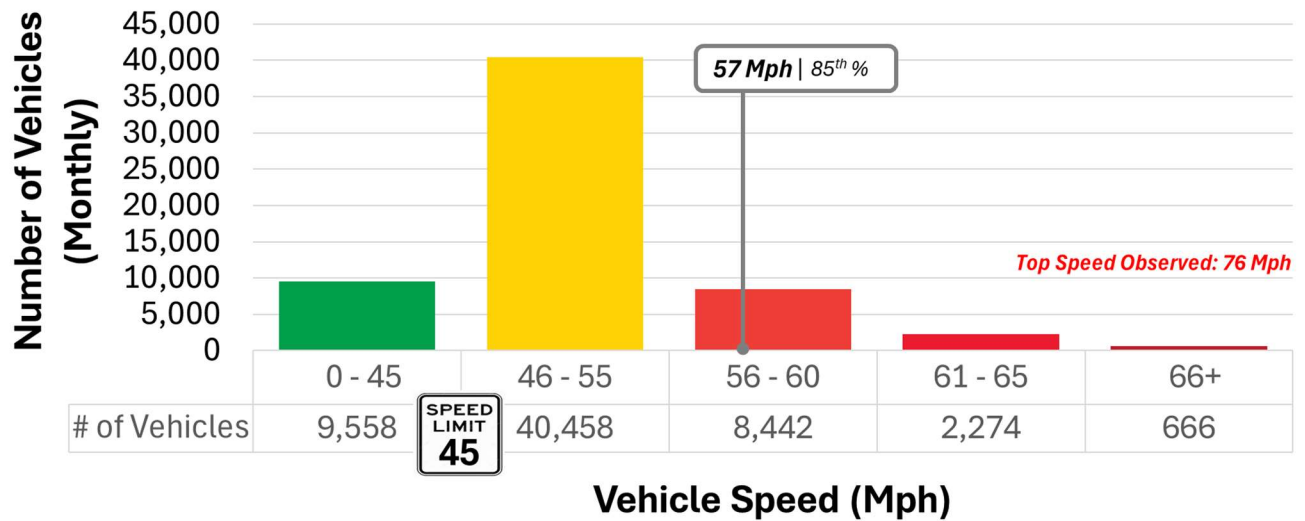

Speed (Mph)	Average Traffic				% of All Traffic	
	Daily		Monthly			
66+	22.2		666.0		1.1%	
61 - 65	75.8	379	2,274.0	11,382	3.7%	18.5%
56 - 60	281.4		8,442.0		13.7%	
46 - 55	1,348.6	1,349	40,458.0	40,458	65.9%	65.9%
0 - 45	318.6	319	9,558.0	9,558	15.6%	15.6%
Total	2,047		61,398		100%	

Data Source: CT DOT Traffic Monitoring (11/30/21 - 12/03/21)

ii. Site Crash History

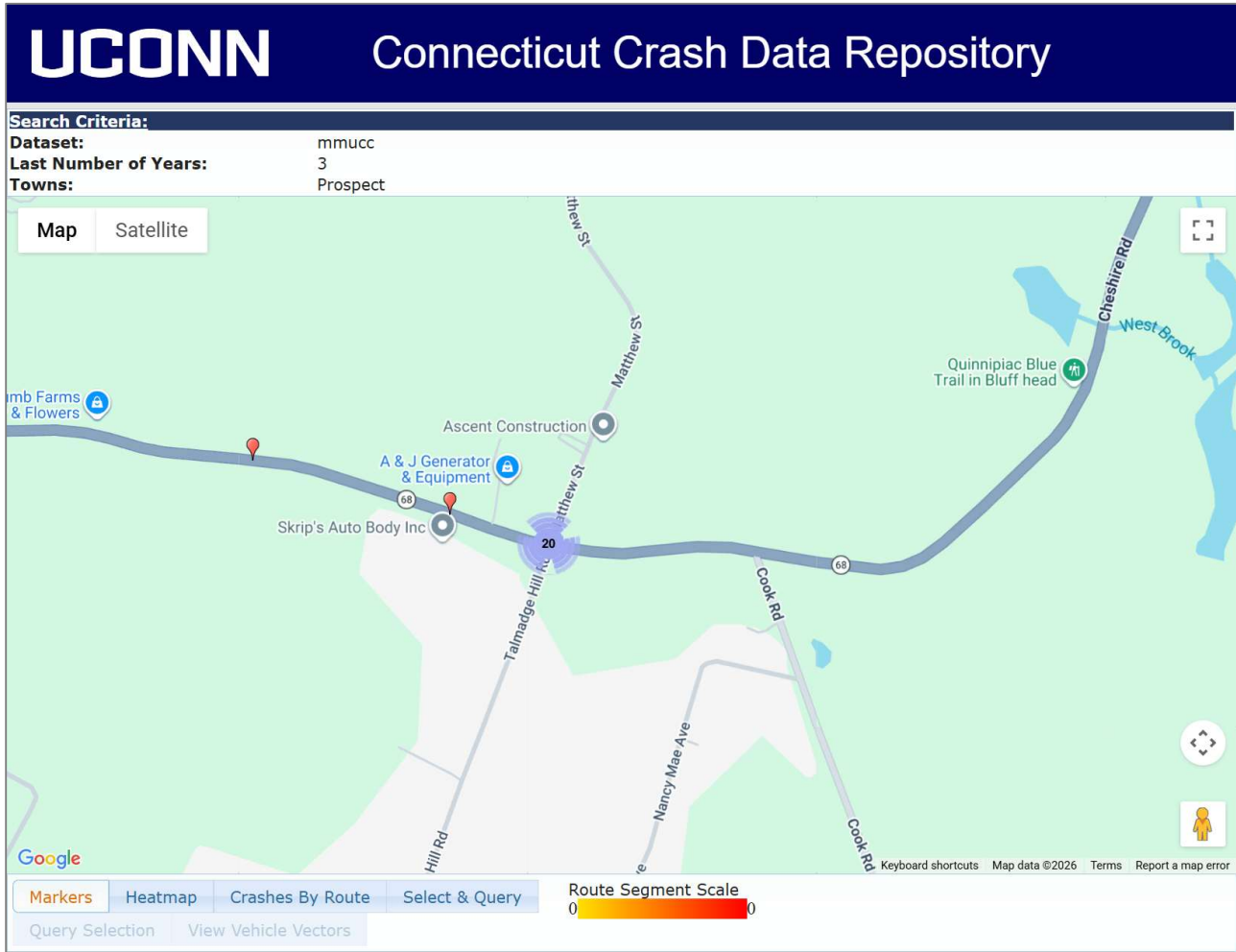

#	CrashId	Town Name	Date Of Crash	Crash Severity	Milemarker	Roadway Name	Intersecting Roadway Name
1	1018006	Prospect	1/12/2023	Injury of any type (Serious, Minor, Possible)	5.32	68-E	MATTHEW ST
2	1042078	Prospect	4/7/2023	Property Damage Only	5.32	68-E	MATTHEW ST
3	1062418	Prospect	6/23/2023	Property Damage Only	5.32	68-E	MATTHEW ST
4	1066698	Prospect	7/11/2023	Property Damage Only	5.22	68-E	null
5	1068239	Prospect	7/4/2023	Property Damage Only	1.83	MATTHEW ST	RT 68
6	1089481	Prospect	9/26/2023	Injury of any type (Serious, Minor, Possible)	5.32	68-E	MATTHEW ST
7	1109804	Prospect	11/26/2023	Injury of any type (Serious, Minor, Possible)	5.32	68-E	MATTHEW ST
8	1118144	Prospect	12/18/2023	Injury of any type (Serious, Minor, Possible)	5.32	68-E	MATTHEW ST

#	CrashId	Town Name	Date Of Crash	Crash Severity	Milemarker	Roadway Name	Intersecting Roadway Name
9	1146217	Prospect	1/5/2024	Injury of any type (Serious, Minor, Possible)	5.32	68-E	Talmadge Hill Rd
10	1147639	Prospect	4/4/2024	Injury of any type (Serious, Minor, Possible)	5.32	68-E	TALMADGE HILL RD
11	1193175	Prospect	8/5/2024	Injury of any type (Serious, Minor, Possible)	5.32	68-E	MATTHEW ST
12	1201927	Prospect	8/29/2024	Injury of any type (Serious, Minor, Possible)	5.32	68-E	MATTHEW ST
13	1227087	Prospect	12/4/2024	Property Damage Only	5.32	68-E	MATTHEW ST
14	1228625	Prospect	12/12/2024	Injury of any type (Serious, Minor, Possible)	5.32	68-E	MATTHEW ST
15	1230323	Prospect	12/10/2024	Property Damage Only	5.32	68-E	MATTHEW ST
16	1242694	Prospect	1/15/2025	Property Damage Only	5.32	68-E	TALMADGE HILL RD
17	1264179	Prospect	4/5/2025	Property Damage Only	5.02	68-E	null
18	1276766	Prospect	5/23/2025	Injury of any type (Serious, Minor, Possible)	1.83	MATTHEW ST	Cheshire Rd
19	1289983	Prospect	7/4/2025	Fatal (Kill)	5.32	68-E	MATTHEW ST
20	1299983	Prospect	6/23/2025	Injury of any type (Serious, Minor, Possible)	5.32	68-E	Talamadge Hill Rd
21	1306350	Prospect	8/29/2025	Injury of any type (Serious, Minor, Possible)	5.32	68-E	TALMADGE HILL RD
22	1326495	Prospect	10/27/2025	Injury of any type (Serious, Minor, Possible)	5.32	68-E	TALMADGE HILL RD

MUNICIPAL PLAN CONTACT INFORMATION

For information related to this Prospect ATESD Plan please contact the following:

Prospect ATESD Plan Author Contact:

Director of Public Safety
Nelson Abarzua
8 Center Street
Prospect, CT, 06712
203-758-6609
ltabarzua@prospectpolice.org

Prospect Permit Submission Staff Liaison:

Sergeant Jason Carrier
8 Center Street
Prospect, CT, 06712
203-758-6609
sgtcarrier@prospectpolice.org